

TAB Magic

| ORDER INFORMATION | |
|-----------------------------|------------------------|
| Short code | M54 |
| TAB ID | 189054 |
| DIN marking | 55401 SMF |
| Quantity per EUR/CNT pallet | 60/120 Pcs |
| TECHNICAL INFORMATION | |
| Voltage | 12 V |
| Capacity C20 | 54 Ah |
| CCA -18°C EN | 510 A |
| DIMENSION AND WEIGHTS | |
| Length/Width/Height | 207x175x175 mm |
| Lead weight | 7.1 kg |
| Electrolyte weight | 3.9 kg |
| Total weight | 12.3 kg |
| TECHNOLOGY | |
| Type | Flooded |
| Grid type | Expanded |
| Grid alloy | Ca/Ca |
| Separator | PE |
| Electrolyte | 1.28 g/cm ³ |
| BOX DESIGNS | |
| Container type | L1B |
| Colour | Black |
| Polarity | 0 |
| Base hold down | B13 |
| Cover type | SMF |
| Layout | 0 |
| Terminal | 1 |

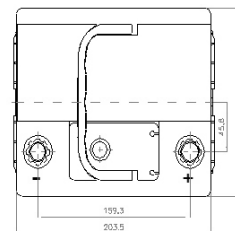

Base hold down

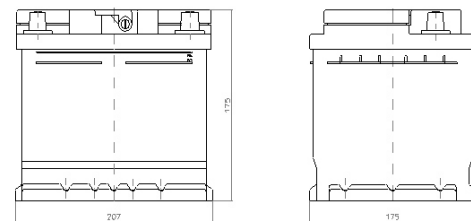

Layout

