

# MB20E - MB21E - MB21EU

# Presses de marquage à chaud

*Ideali per marcare legno, plastiche e tessuti! Ideal to mark fabrics, plastics and wood!*

*Ideal para marcar madera, plastico y tejidos!*

## MACCHINE A CALDO MANUALI, PNEUMATICHE E DA LINEA

Azionamento manuale o pneumatico della cremagliera

Termostato per la regolazione della temperatura in base al materiale

Svolginastro con avanzamento automatico per marcature colorate

Molti gli accessori disponibili tra cliché, caratteri e numeratori per personalizzare facilmente la marcatura

## MANUAL, PNEUMATIC HOT MACHINES AND UNITS

Manual or pneumatic actuation of the rack

Thermostat for the temperature regulation, according to the material

Ribbon automatic advance to have colored marking

Many accessories available, such as cliché, types, type-holders, numbering heads to personalize the marking



MB21EU

### TraçaMatrix

ZAC de la Marjolaine  
6 avenue du Docteur Pramayon  
13690 GRAVESON

Tel: 04 90 95 08 97  
info@tracatrix.com  
www.tracatrix.com

MB20E

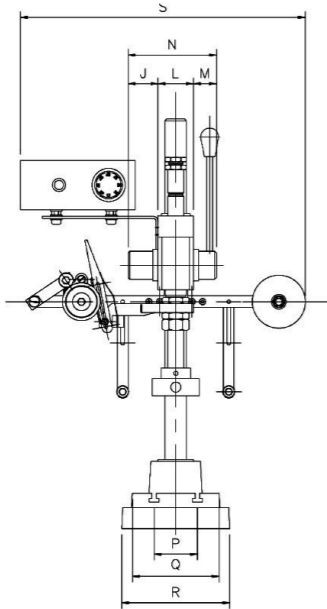
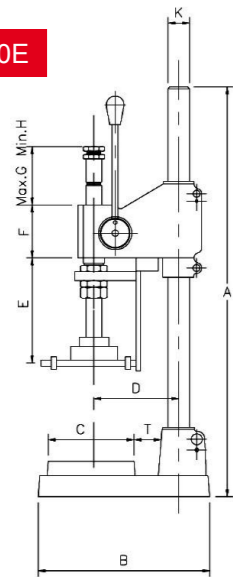

MB21EU

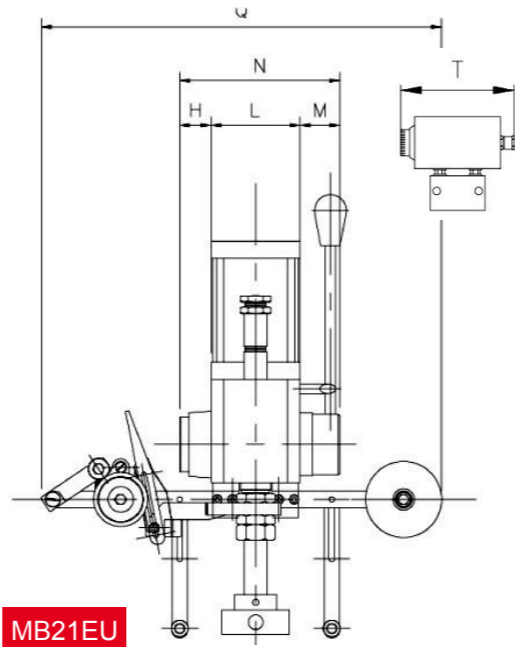

MB21E

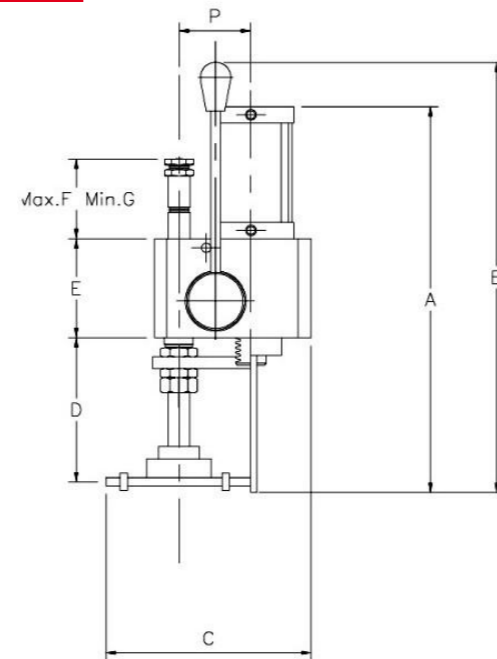
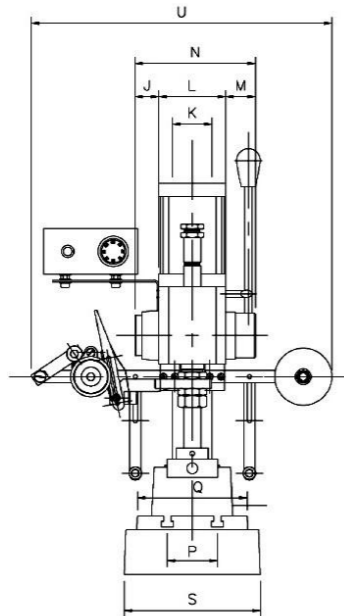
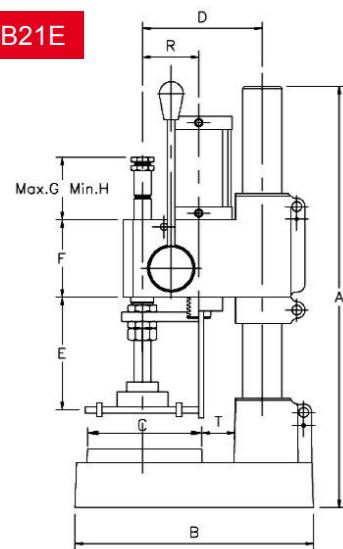

MB21E



MB20E

	A	B	C	D	D <sup>(1)</sup>	D <sup>(2)</sup>	E	E <sup>(1)</sup>	E <sup>(2)</sup>	F	G	H	K	J	L	M	N	P	Q	R	S	T	U
20E	650	309	160	160			60	170	102	110	80	42	57,5	66	42,5	166	80	160	205	468	45		
21E	600	355	176	180			177	65	118	150	110	60	37	102	44	183	80	168	84	208	50	475	
21EU	435	355	250		177	65	115			150	110	40			100	44	184	84	475				

Dimensioni - Dimensions - Dimensiones (mm)

Potenza regolabile - Adjustable power - Potencia (kg / kN)

Luce massima - Maximum light - Luz max (mm)

con gruppo riscaldatore - with heating block - con grupo calentador

senza gruppo riscaldatore - without heating block - sin grupo calentador

Peso netto - Net weight - Peso Neto (kg)

Cava a T - T cave - Ranura en T (mm)

Diametro codolo - Shank diameter - Diámetro de la espiga (mm)

Corsa cremagliera - Rack stroke - Carrera de la cremallera (mm)

Corsa utile - Usable stroke - Carrera útil (mm)

	MB20E	MB21E	MB21EU
Dimensioni - Dimensions - Dimensiones (mm)	205x650x309	208x600x355	435x250x475
Potenza regolabile - Adjustable power - Potencia (kg / kN)	50 / 0,5	150 / 1,5	150 / 1,5
Luce massima - Maximum light - Luz max (mm)	275	206	
con gruppo riscaldatore - with heating block - con grupo calentador	385	318	
senza gruppo riscaldatore - without heating block - sin grupo calentador			
Peso netto - Net weight - Peso Neto (kg)	38,5	58	27,5
Cava a T - T cave - Ranura en T (mm)	10	10	
Diametro codolo - Shank diameter - Diámetro de la espiga (mm)	dia 27	dia 27	dia 27
Corsa cremagliera - Rack stroke - Carrera de la cremallera (mm)	65	67	67
Corsa utile - Usable stroke - Carrera útil (mm)	65	67	67