



Porte coulissante pour température positive et négative composée en standard de trois éléments essentiels :

**CADRE STANDARD** : en profile PVC rigide renforcé à l'intérieur par des profilés en acier, les portes BT avec cordon Chauffant posé sous un profilé aluminium anodisé avec couvercle pour un changement facile.

**VANTAIL STANDARD** : isolé en mousse de polyuréthane injectée à haute pression densité 40 à 45 kg/m<sup>3</sup> entre deux tôles en acier pré-laqué entouré d'un profilé en aluminium anodisé et profilé PVC de rupture de pont thermique munis des rainures pour la pose facile des joints d'étanchéité.

**EPAISSEUR** : 60.80mm pour T° positive, Epaisseur : 100.120mm pour T° négative.

**SYSTEME DE COULISEMENT** : en profile aluminium anodisé avec guidage au sol de coulissement et de serrage pour une parfaite étanchéité, l'ouverture et la fermeture est assurée par poignée extérieure et intérieure en inox.



Sliding door for positive and negative temperature standard composed of essential parts :

**STANDARD FRAME** : with rigide PVC profile has reinforced internally with steel profile, the low temperature is equipped with a heating cable installed under on a profile anodized aluminium with cover for easy change.

**STANDARD LEAF** : insulated polyurethane foam injected at hight pressure, density 40 to 45kg /m<sup>3</sup> between two sheet metal prepainted steel surround a profile anodized aluminium and PVC profile termal stop for the easy installation of sealing gaskets.

**THICKNESS** : 60.80mm for 6° to 0°C Temperature . Thickness : 100.120mm for 0° to -40°C Temperature.

**SLIDING SYSTEME** : in anodized aluminium profiles for up to 250KG with aluminium front guiding profile and floor guide blocks for a perfect seal closing opening and closing is provided by internal and external handle stainless steel .

- Dimensions standard  
- Standard dimensions

CO60P L X H	CO80P L X H	CO100N L X H	CO120N L X H
800X2000	800X2000	800X2000	800X2000
800X2200	800X2200	800X2200	800X2200
900X2000	900X2000	900X2000	900X2000
900X2200	900X2000	900X2200	900X2200
1000X2000	1000X2000	1000X2000	1000X2000
1000X2200	1000X2200	1000X2200	1000X2200
1100X2000	1100X2000	1100X2000	1100X2000
1100X2200	1100X2200	1100X2200	1100X2200
1200X2000	1200X2000	1200X2000	1200X2000
1200X2200	1200X2200	1200X2200	1200X2200
1200X2400	1200X2400	1200X2400	1200X2400
1300X2000	1300X2000	1300X2000	1300X2000
1300X2200	1300X2200	1300X2200	1300X2200
1300X2400	1300X2400	1300X2400	1300X2400
1400X2000	1400X2000	1400X2000	1400X2000
1400X2200	1400X2200	1400X2200	1400X2200
1400X2400	1400X2400	1400X2400	1400X2400
1500X2000	1500X2000	1500X2000	1500X2000
1500X2200	1500X2200	1500X2200	1500X2200
1500X2400	1500X2400	1500X2400	1500X2400
1600X2000	1600X2000	1600X2000	1600X2000
1600X2200	1600X2200	1600X2200	1600X2200
1600X2400	1600X2400	1600X2400	1600X2400
1800X2000	1800X2000		
1800X2200	1800X2200		
1800X2400	1800X2400		
1800X2600	1800X2600		
1800X2800	1800X2800		
2000X2200	2000X2200		
2000X2400	2000X2400		
2000X2600	2000X2600		
2000X2800	2000X2800		
2000X3000	2000X3000		
2000X3200	2000X3200		
2200X2400	2200X2400		
2200X2600	2200X2600		
2200X2800	2200X2800		
2200X3000	2200X3000		
2200X3200	2200X3200		
2400X2400	2400X2400		
2400X2600	2400X2600		
2400X2800	2400X2800		
2400X3000	2400X3000		
2400X3200	2400X3200		
2500X2500	2500X2500		
2500X2800	2500X2800		
2500X3000	2500X3000		
2500X3200	2500X3200		
3000X3000	3000X3000		
3000X3200	3000X3200		
3000X3500	3000X3500		

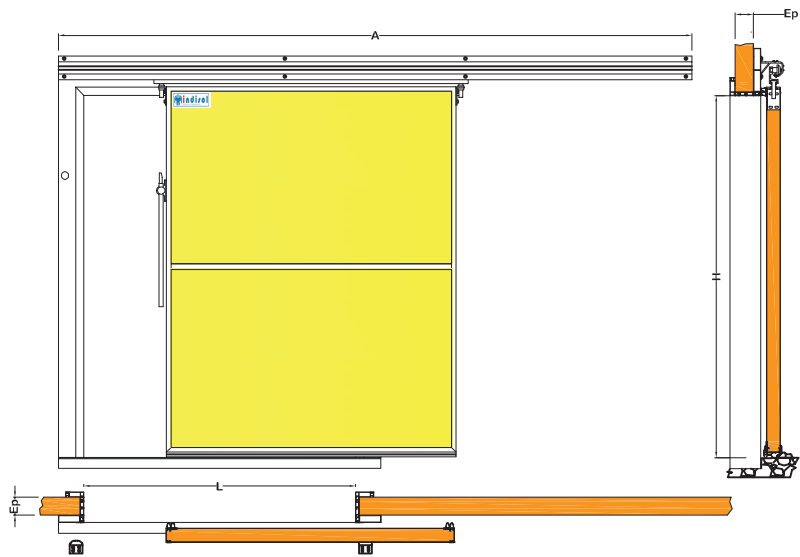

## FIXATION - FIXING

Fixation avec cadre et contre cadre  
Fixing with internal fram

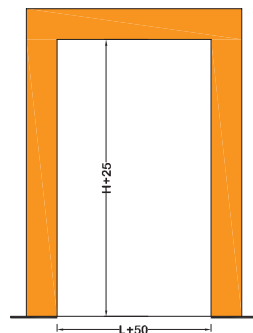

Fixation sur maçonnerie  
Fixing on brick wall

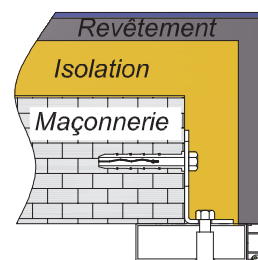
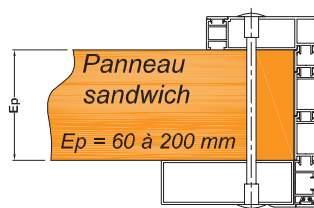
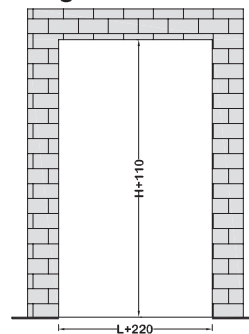

Dimensions de réservation sur panneaux  
Hole dimensions for doors panel

Dimensions de réservation sur maçonnerie  
Hole dimensions for doors on brick wall

## SEUILS

## THRESHOLDS

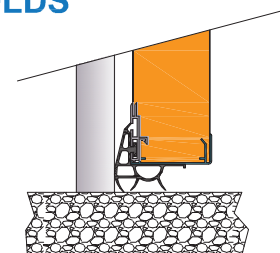
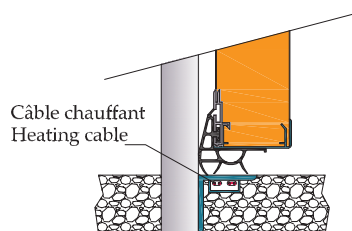
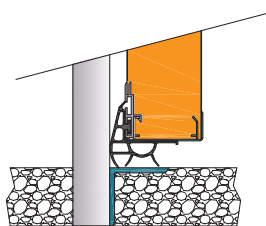

**SF Positive**

Seuil à fil de sol T° Positive  
Threshold for same level floor Positive T°

**SF Négative**

Seuil à fil de sol T° Négative  
Threshold for same level floor Négative T°

**SS Positive**

Sans seuil T° Positive  
Without Threshold Positive T°