

UNIVERSAL LED DISPLAY

FEATURES

- Serial RS485 input
- Bright red color display
- Compact and rugged design
- Low cost

APPLICATIONS

- Inclination display
- Driver-cabin display
- Safety alarm



DESCRIPTION

ARN LD2-2 is a standalone LED display which integrates with Aeron's digital tilt sensors and tilt switches.

It has 4 digit 2 row 7½ segment LEDs for displaying X and Y axis angles. The ARN LD2-2 is a panel mountable display ideally suited for angle monitoring applications.



TECHNICAL SPECIFICATIONS

Parameter	Parameter Value/Description
Serial input format	RS 485 (ASCII)
Baud rate	9600 (Fixed)
Data bits	8
Parity	None
Stop bit	1
Data update rate	10 Hz (maximum)
Data format	Aeron's Proprietary Format (TS2D / TSW / TSWG)
Display	Dual row, 7 segment LED
Display resolution	Up to 4 digits (with floating decimal)
Operating voltage	+12 to +24 VDC
Current Consumption	<100 mA
Size	122 mm (L) x 120mm (W) x 80mm (H)
Weight	1 kg
Operating temperature	-20 to +70 °C
Ingress Protection	IP65

MECHANICAL DIMENSIONS

All dimensions are in mm.

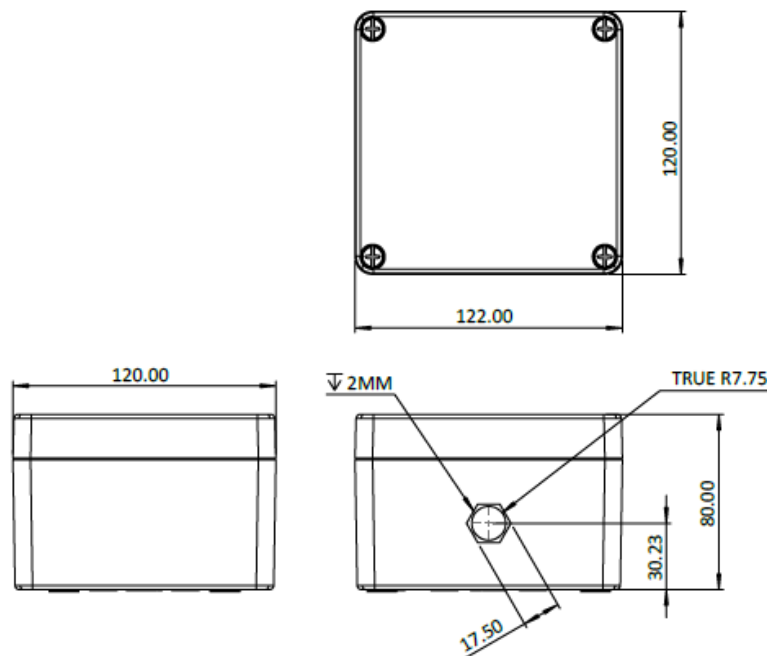

ORDERING INFORMATION

ARN LD2-2 (Product Code: 15002)