

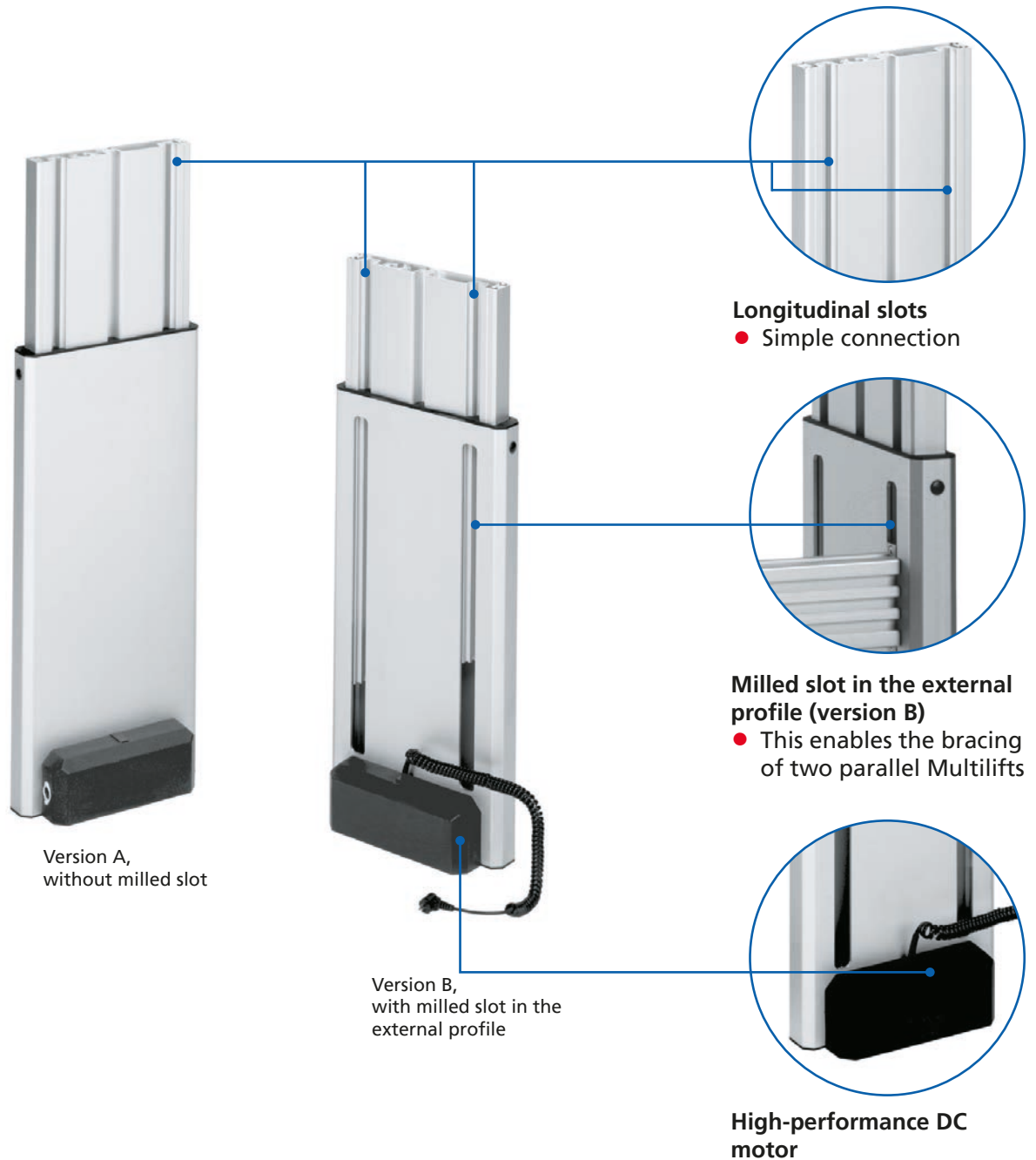

Slimline design and an unbeatable price/performance ratio



Highlights / Features:

- Quadruple bearings with POM slide bearing shells
- High-performance DC motor
- Integrated limit switches
- Self-locking, even under max. load

Options:

- Special stroke lengths
- Quadro control enables control of up to 32 columns synchron
- Tested to EN 60601-1 (3E)

Table of contents

| | | | |
|--------------------|-----------------------|------------------------|---------|
| Versions | Lifting column | Multilift Synchro..... | Page 38 |
| Accessories | Fixing | Adaptor bar | Page 40 |
| | | Assembly plate | Page 42 |
| | | RK SyncFlex | Page 43 |
| | | Foot | Page 44 |

Technical data

General information/operating conditions

| Type | Multilift | Custom |
|---|--|---------|
| Design | Slim lifting column | |
| Guide | POM slide bearings | |
| Installation position | Any position / suspended with drop protection provided by the customer | |
| Push force* | 3000 N or 1000 N | |
| Pull force* | 1000 N (only in conjunction with factory-mounted base plate) | |
| Self-locking | Yes | |
| Max. travel speed | 6 mm/s or 13 mm/s | |
| Max. stroke | 498 mm | 1200 mm |
| Installation dimension | Stroke + 206 mm (incl. base plate) | 1600 mm |
| Voltage | 24 V DC | |
| Current output | 3 A or 4 A | |
| Protection class | IP 20 (in connection with the assembly plate) | |
| Ambient temperature | +5°C to +40°C | |
| Displacement during synchronous operation | 0 to 4 mm | |
| Duty cycle | At nominal load, 10% (max. 2 mins operating time, 18 mins rest time) | |

*Note:

All information refers to the standard sizes. All data of push/pull forces are referring to the individual lifting column, for combined applications a safety factor of up to 0,6 has to be considered.

In medical applications, the maximum pull force of 500 N and, in the case of the version with a travel speed of 8 mm/s, the maximum push force of 2000 N must not be exceeded.

Load data

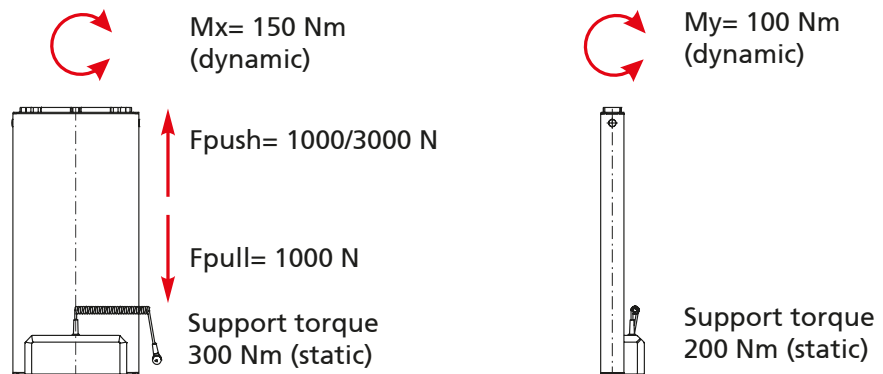

| Drive | Push force [N] | Travel speed [mm/s] | Number of assigned motor channels | | | |
|-----------|----------------|---------------------|-----------------------------------|---|-------------|-------------|
| | | | 1 | 2 | 3 | 4 |
| Multilift | 1000 | 13 | ✓ | ✓ | ✓ | je 750 N |
| Multilift | 3000 | 6 | ✓ | ✓ | each 2200 N | each 1500 N |

Note:

If more than 2 drives are to be operated synchronously at nominal load, BUS communication between two or more MultiControl II duo controllers is required.

The necessary accessories can be found on page 172.

The procedure for setting up BUS communication is described in detail in the operating manual.



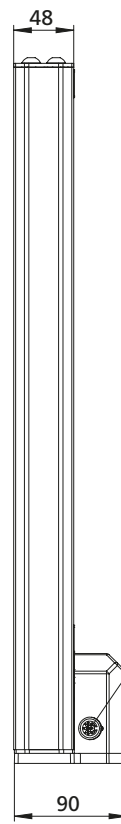
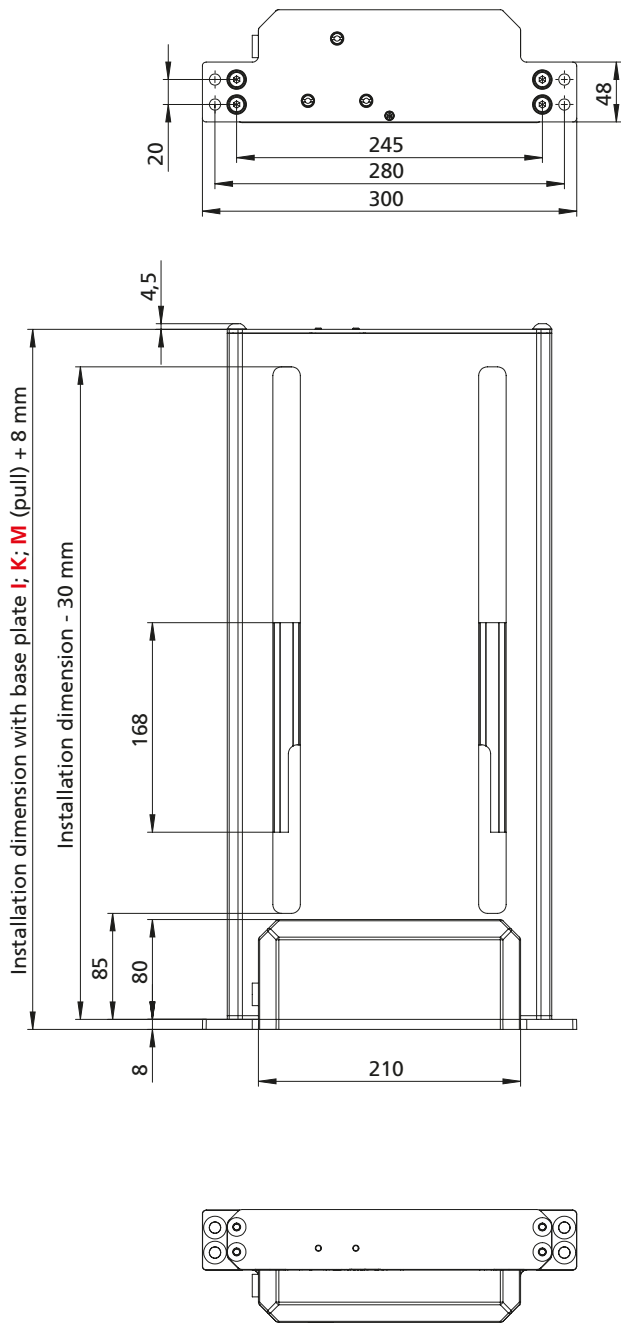

Versions

Multilift

The Multilift is used for continuously variable height adjustment of tables, assembly workstations and equipment etc. The lifting column can be operated individually or in synchronously as a pair. With lifting forces of up to 3000 N and a maximum stroke of 498 mm in the standard range, this lifting column is suitable for a wide range of applications. A version of the Multilift with milled slots in the inner profile is also available. They can be used, for instance, for connecting accessories and for stabilising table attachments.



Special features:

- High-performance DC motor
- Integrated limit switches
- Self-locking, even under max. load
- Special stroke lengths available on request

Ideal areas of application:

- Workplace ergonomics
- Industrial technology
- Media technology

Multilift Synchro

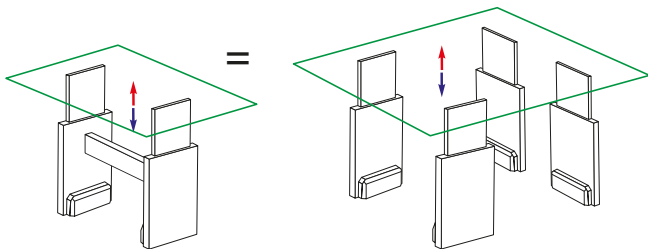

2-4 Multilifts in synchronous operation

Synchronous operation

Synchronous operation of two or more columns. In conjunction with the integrated sensors, the control (see page 156) ensures synchronisation, and thus constant alignment of all the columns in both directions of travel, even if subject to different loads. The synchronous operation tolerance depends on the lifting speed and is max 2 mm on the 6 mm/s version and max 4 mm on the 13 mm/s version. A memory function is also available.



Universal Table Ironing Machine

Version A
without milled slot in
the external profile



Version B
with milled slot in
the external profile

**Note:**

A separate adapter cable is required to use the Multilift on the MultiControl II.
This can be found on 173

| Code No. | Type | max. push force [N] | max. pull force [N] | max. lifting speed [mm/s] | Total travel [mm] | Installation dimension incl. base plate [mm] | Weight [kg] |
|---------------|-----------------|---------------------|---------------------|---------------------------|-------------------|--|-------------|
| QAB13_G0_0355 | Multilift 350 | 3000 / 2000 (med.) | 1000 / 500 (med.) | 6 | 355 | 558 | 10.1 |
| QAB13_G0_0400 | Multilift 400 | | | | 400 | 603 | 11.0 |
| QAB13_G0_0450 | Multilift 450 | | | | 452 | 658 | 11.8 |
| QAB13_G0_0500 | Multilift 500 | | | | 498 | 703 | 12.5 |
| QAB26_G0_0355 | Multilift 350 s | 1000 / 1000 (med.) | 1000 / 500 (med.) | 13 | 355 | 558 | 10.1 |
| QAB26_G0_0400 | Multilift 400 s | | | | 400 | 603 | 11.0 |
| QAB26_G0_0450 | Multilift 450 s | | | | 452 | 658 | 11.8 |
| QAB26_G0_0500 | Multilift 500 s | | | | 498 | 703 | 12.5 |

Version:

- 3 = B (with milled slot in the external profile)
4 = A (without milled slot in the external profile)

Base plate (For dimensions, see below):

- I** = with external fixing plates
4 counterbores
K = with external fixing plates
2 counterbores
M = base plate flush

Dimension base plate

Base plate (**I**) with
fixing plates
(4 counterbores)

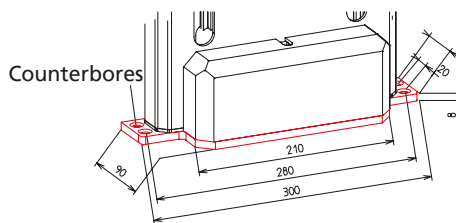

Base plate (**K**) with
fixing plates
(2 counterbores)

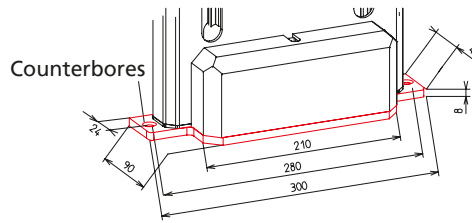

Base plate (**M**)
flush

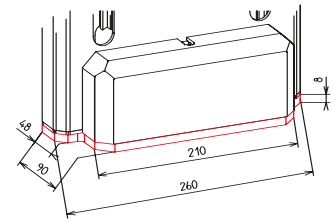
**System components**

| Code No. | Accessories | |
|---------------|--|-----------|
| Controls | | |
| QST10H12AA000 | MultiControl II duo - Basic | Multilift |
| QST10H14AA000 | MultiControl II quadro - Basic | |
| Hand switches | | |
| QZB11G07AV041 | Hand switch with 6 function keys and display – 1 m cable lenth | |
| QZB11G07AB041 | Hand switch with 2 function keys – 1 m cable lenth | |
| QZD000074 | Hand switch drawer for hand switch with 6 and 2 function keys | |
| IEC connector | | |
| QZD070618 | IEC cable (Europe version, earthed plug) | |

| Code No. | Length [mm] | Adapter cable |
|-----------|-------------|---|
| QZD020722 | 200 | Adapter cable Multilift I on MultiControl II 0,2 m |
| QZD020711 | 2500 | Connecting cable Multilift I on MultiControl II 2,5 m |



Note: Further accessories (hand switches, connecting cables etc.) can be found in the chapter „Controls and accessories“ starting on page 152

Accessories

Adaptor bar

- Cross struts from the BLOCAN® Profile Assembly System are used to increase the stability of two version B Multilifts (see page 34). The adaptor bar is suitable for F profile 40 x 80 L and F 30x60.

Material: AlMgSi 0.5
Fixing set, zinc plated

Scope of delivery:
2x adaptor bars, fixing set

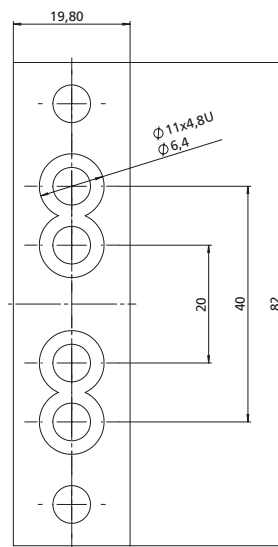
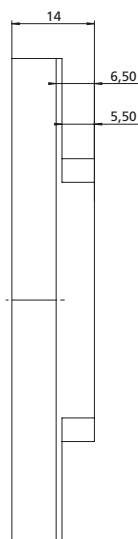
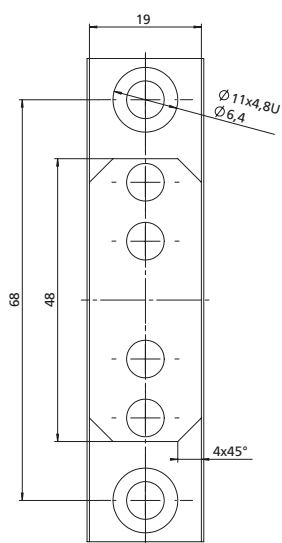
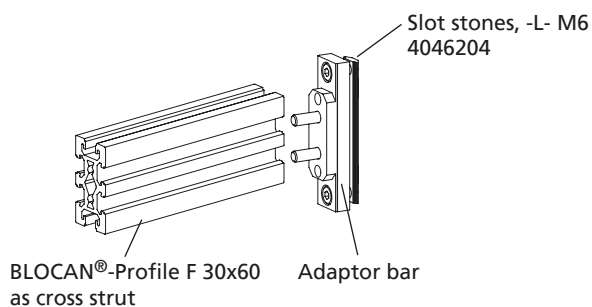

| Code No. | Version |
|-----------|---|
| QZD020020 | Adaptor bar for BLOCAN® profiles |
| 4285000 | Profile* F-40 x 80-L, can be cut to specification |



Length (clear width between the Multilifts -2 mm)

* For dimensions of the profiles, please refer to the catalogue BLOCAN PROFILE TECHNOLOGY



Fixing

Multilift assembly plates / compression plate

Material: Die-cast, black powder-coated zinc plated fixing set

Scope of delivery: 1x assembly or thrust compression plate fixing set

Note:

The "top" assembly plates listed here and the thrust compression plate are only suitable for push loads. For applications involving pull force and in synchronised groups, a base plate – factory-mounted on the Multilift – must be used.

You will find further information in the operating manual

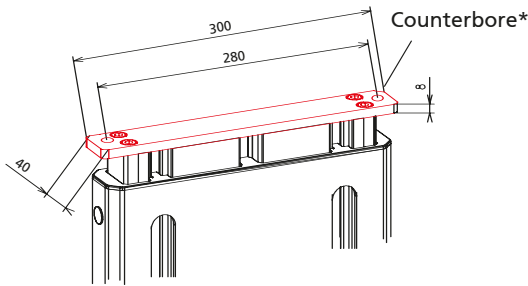

Top assembly plate

* DIN 74 - F8

| Code No. | Version | Multilift | |
|-----------|--------------------|------------------|------------------|
| | | Internal profile | External profile |
| QZD020549 | Top assembly plate | • | |

Fixing plate



- This universal plate can be bolted directly into the screw channel of the lifting column using a fixing set. The numerous pre-drilled holes in the metal make it easy to attach table tops, brackets, etc.

Material: steel, black powder-coated (RAL 9005), zinc plated fastenings

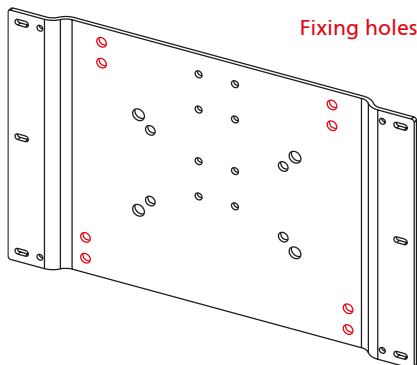

Fixing holes

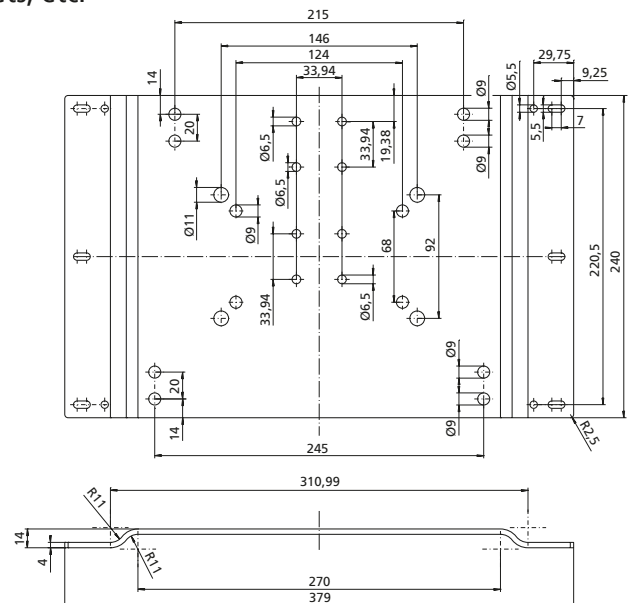

| Code No. | Version | Multilift | |
|-----------|----------------------------------|------------------|------------------|
| | | Internal profile | External profile |
| QZD100313 | Fixing plate | • | |
| QZD120336 | Fixing set, 4x M6 x 14, DIN 7984 | | |

Fixing

RK SyncFlex H

Scope of delivery:
Adjuster plate, incl. fixing material



Horizontal alignment

- To prevent locked-up stress in mechanically overdefined bearing systems (more than one fixed bearing) around the horizontal axis.
With RK SyncFlex H defined loose bearings supplement the application.

- The horizontal compensation in the Z-axis enables the freedom of movement required when moving the lifting columns.

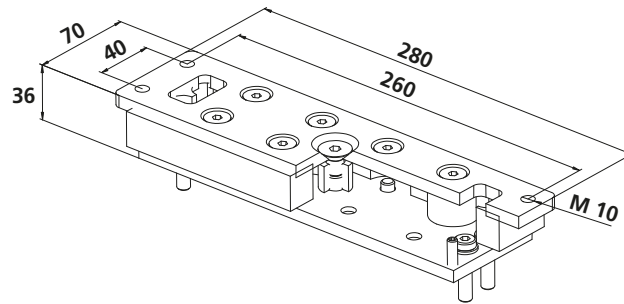

[mm]

| Code No. | Type | Max. load | Multilift | |
|-----------|-----------|-----------|------------------|------------------|
| | | | Internal profile | External profile |
| QZD020471 | Multilift | 3000 N | • | |

RK SyncFlex V

Scope of delivery:
Adjuster plate, incl. fixing material

Option:
Optionally available with or without pressure plate (see table)

Vertical alignment

- If the lifting columns are not parallel, the distance between the two upper fixing points will change during the movement. However, a rigid connection keeps this distance constant, and this means that the lifting columns are subject to very strong forces.

RK SyncFlex V enables the compensation of unevenness in the mounting environment.

- The lifting columns can be aligned via the vertical adjustment around the X-Y axes.

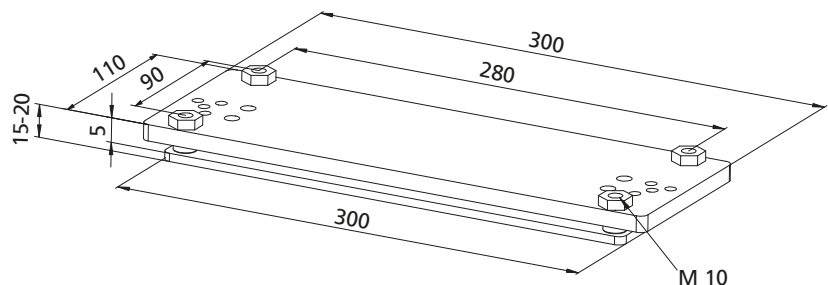

[mm]

| Code No. | Type | Max. load | Multilift | |
|------------------------|-----------|-----------|------------------|------------------|
| | | | Internal profile | External profile |
| Without pressure plate | | | | |
| QZD020472 | Multilift | 3000 N | ● * | ● |
| With pressure plate | | | | |
| QZD020462 | Multilift | 3000 N | | |

• * = in connection with the assembly plate (page 42)

Accessories

Foot

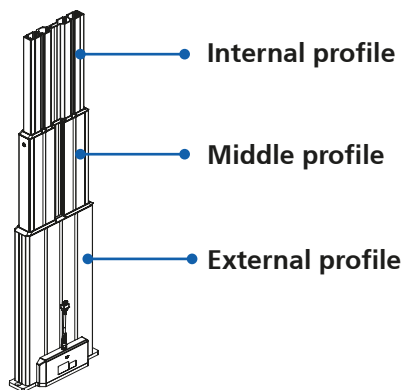

- Different foot versions for the Multilift
- No modifications to the Multilift required

Material:

Type 1/2/5 GK-ALSi12/3.2583.02, black powder-coating

Type 3/4 steel tube, ends capped black powder-coating

Scope of delivery:

one foot with fixing set

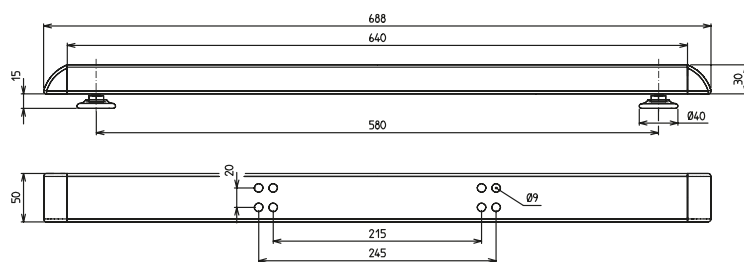
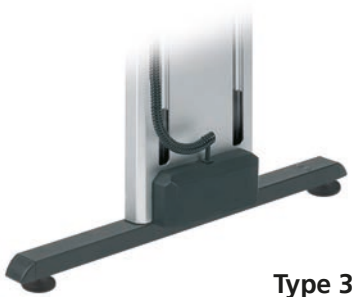
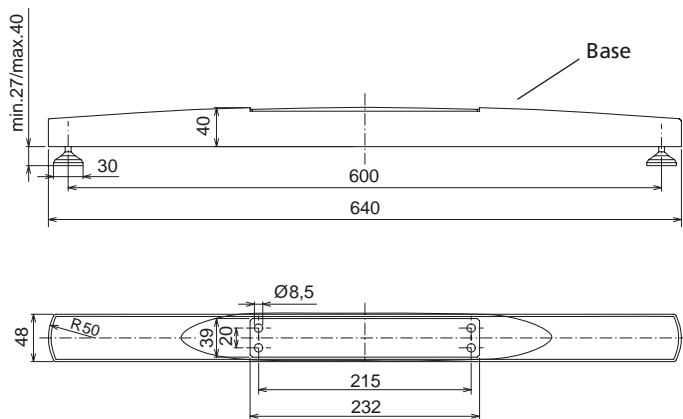
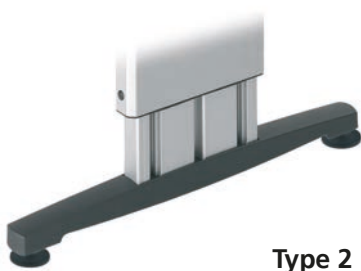
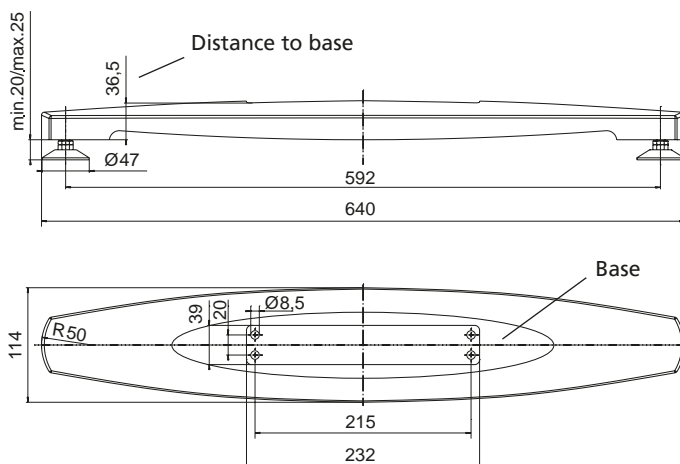

Multilift centrally mounted
(choice of internal or external
profile)



Type 4

Multilift mounted off-centre
(choice of internal or external
profile)

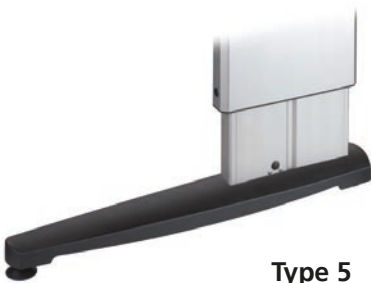
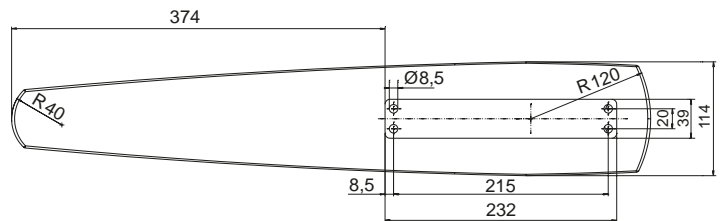
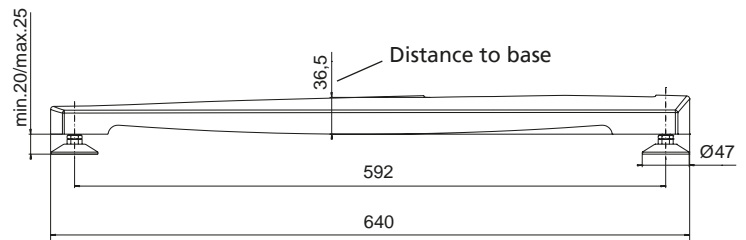
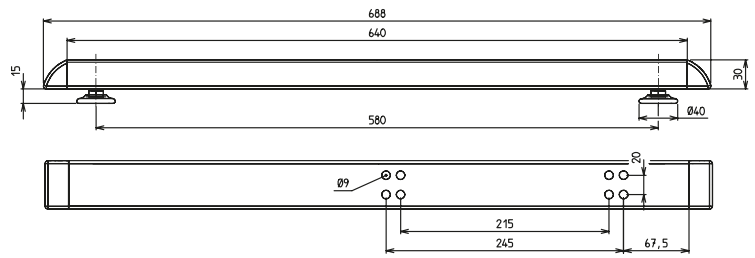

Type 5

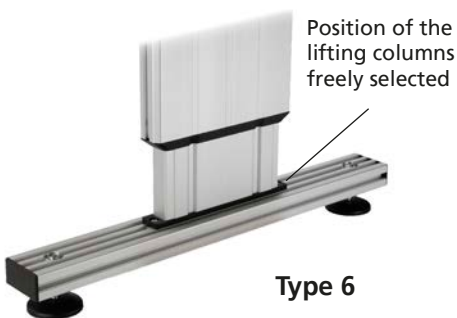
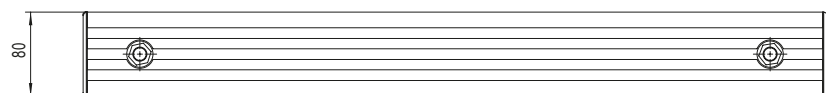
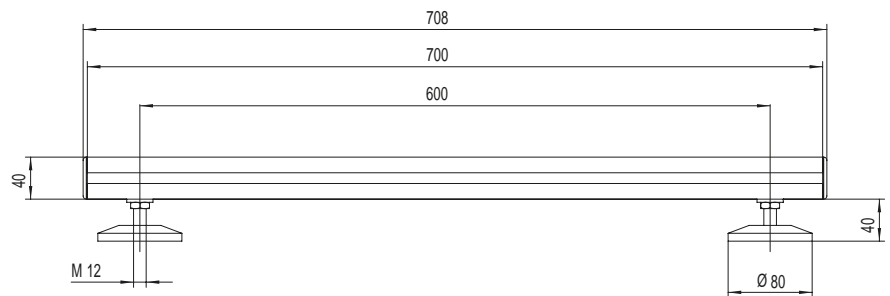

Type 6

| Code No. | Type | max. load | Multilift | |
|-----------|------|-----------|------------------|------------------|
| | | | Internal profile | External profile |
| QZD020252 | 1 | 1000 N | ● | |
| QZD020253 | 2 | 1000 N | ● | |
| QZD020254 | 3 | 1000 N | ● | ● |
| QZD020255 | 4 | 1000 N | ● | ● |
| QZD020343 | 5 | 1000 N | ● | |
| QZD020256 | 6 | 3000 N | ● | ● |