

Original Operating Manual

SRM-FB 150



Table of contents

1	About this operating manual.....	3
2	Safety.....	4
2.1	Intended use.....	4
2.2	Qualifications of personnel.....	4
2.3	General safety notices.....	4
2.4	Special safety notices.....	5
3	Installation.....	6
3.1	Attaching the snow blade on the tractor.....	6
3.2	Adjustments on the snow blade.....	7
4	Operation and fault correction.....	8
4.1	Operation.....	8
4.2	Faults.....	8
4.3	Contact person.....	9
5	Maintenance.....	10
6	Disposal.....	11
7	Guarantee.....	11
8	Technical data and accessories.....	11
9	List of illustrations.....	11
10	EG - Konformitätserklärung.....	12

1 About this operating manual

Dear customer! Dear customer!

Thank you for purchasing this implement, we appreciate your trust.

Prior to using this implement for the first time, read this operating manual carefully and conscientiously all the way through.

Keep this operating manual where it is easily accessible. This will enable you to refer to important information and handling instructions as needed.

Listings with bullet points are marked as follows:

- Text
- Text
- Text . . .

Handling instructions are marked in the sequence in which they should be executed, as follows:

1. Text
2. Text
3. Text . . .



This implement is subject to change in the interest of technical progress. All information, illustrations, and technical specifications represent the latest status at the time this manual was published. The manufacturer reserves the right to make changes at any time in the interest of technical progress.

2 Safety

Guidelines and instructions with which you must comply, are summarized in this section.

Personnel who mount, operate and maintain this implement, must have read and understood this operating manual.

2.1 Intended use

The snow blade is an implement for winter service and is used for clearing snow from roads, paths, and other areas.

All other uses are excluded.

Non-intended use causes:

- Danger of injury to the operator or third parties
- Damage to the tractor and the implements
- Environmental damage

2.2 Qualifications of personnel

Only personnel 18 years of age or older, or instructed personnel should install, operate, and maintain the snow blade. The operator must have read and understood this operating manual.

2.3 General safety notices

General safety notices are explained in this section. These safety notices are used in the subsequent sections. In addition to the safety aspect, you will save money and work time if you follow these safety instructions.



Danger!

**Severe injury to the operator or third parties occurs.
Comply with the safety notice.**



Attention!

**Minor injury to the operator or third parties can occur. The tractor, the cabin, or the environment can be damaged.
Comply with the safety notice.**



Note!

**Important, helpful tips or information for the operator.
Read this note. It facilitates your work.**



Attention!
Injuries can occur due to improper operation. The implement can be damaged.
Read the operating manual all the way through.
Comply with the safety instructions.



Attention!
Danger of crushing due to moving parts.
Never reach into the crushing hazard zone if parts are moving or can move.
Comply with the notice in the operating manual.

2.4 Special safety notices

Safety instructions are specified in this section that are also affixed as stickers on the implement.



Attention!
Prior to start-up read and comply with the operating manual and the safety instructions.



Attention!
Prior to performing maintenance and repair tasks, turn off the engine and remove the key.

3 Installation



Attention!

Before starting up the implement, read the instructions on safety and handling for operation of the entire implement and connection to the tractor.

3.1 Attaching the snow blade on the tractor

In order to attach the snow blade on a tractor, the tractor must be equipped with a Quick Hitch front power system. The attachment is described in more detail below:

1. Position the snow blade in such a manner that you can drive to just in front of the receptacle of the snow blade.
2. Then the Quick Hitch is lowered all the way and is brought under the receptacle of the snow blade by driving the tractor forward. Ensure that the receptacle of the snow blade threads in between the hooks of the Quick Hitch.

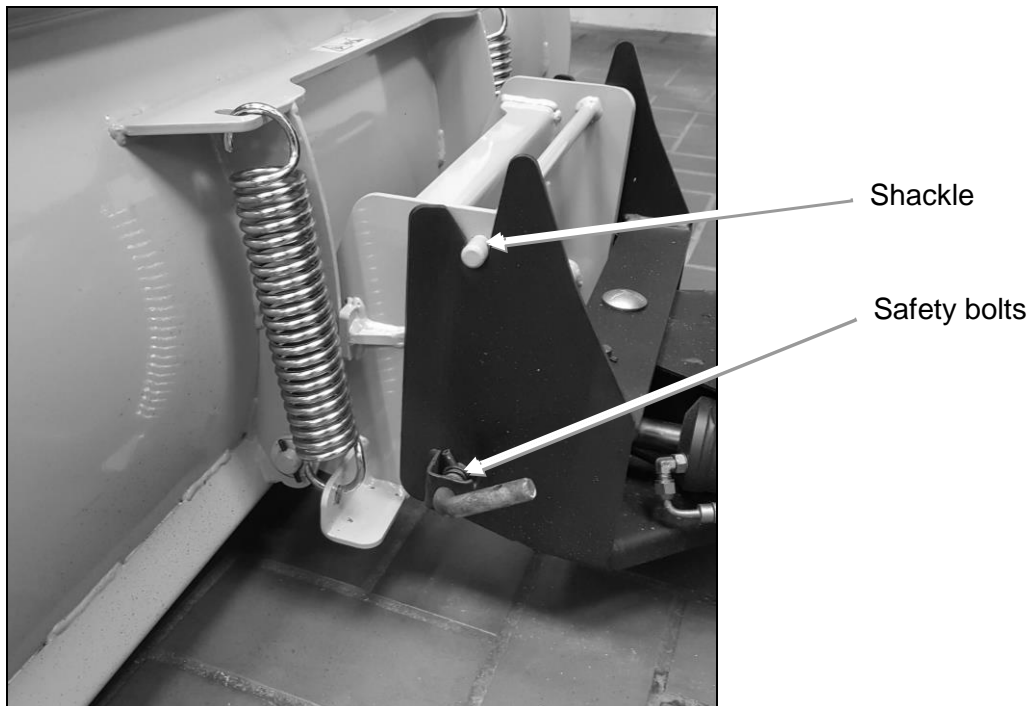

Fig. 1: Attaching on the Quick Hitch

3. Lifting the Quick Hitch causes the bolts to slide into the lugs.
4. Now the two lock bolts on the Quick Hitch must be inserted.

3.2 Adjustments on the snow blade

Before starting to clear snow, the skids must be correctly adjusted. To do this the snow blade is lowered onto a level surface via the hydraulics. The snow blade is correctly adjusted when the skids rest on the ground and the scraper bar just barely touches the ground or clears the ground by 1-2 mm. If this is not the case the snow blade must first be adjusted.

To do this proceed as follows:

1. Lower the snow blade until it is just a little above the ground, and place it on an intermediate substrate that is 1-2 mm thick.
2. Set the hydraulic system to the float position, block, and switch off the tractor.
3. Pull the spring cotter pin and pull out the bolt.
4. Lower the skid to the ground and look for the nearest bore.
5. Insert the bolt and secure it again with the spring cotter pin.

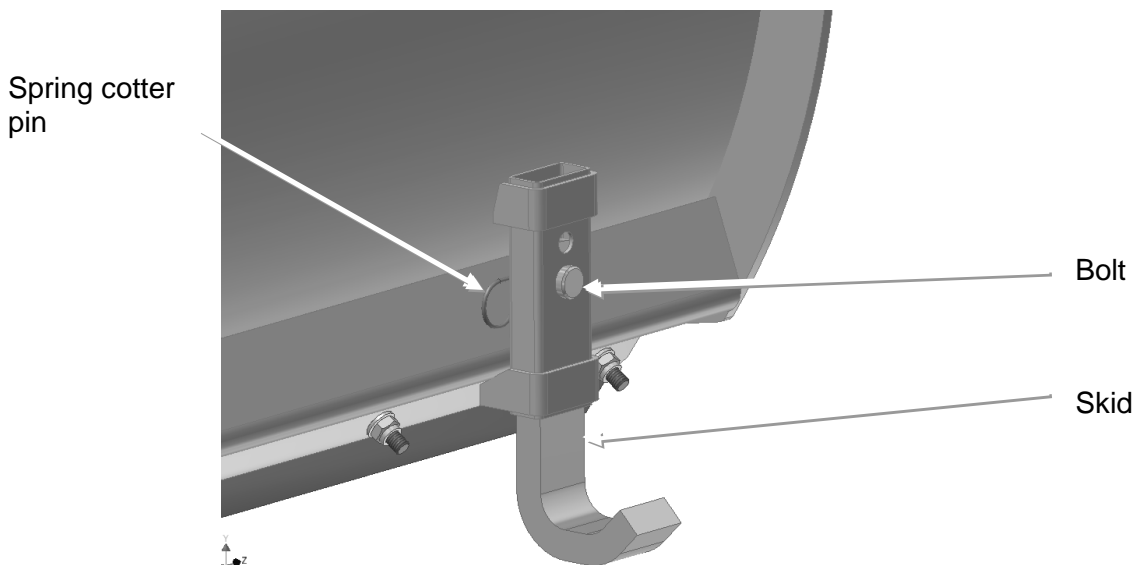
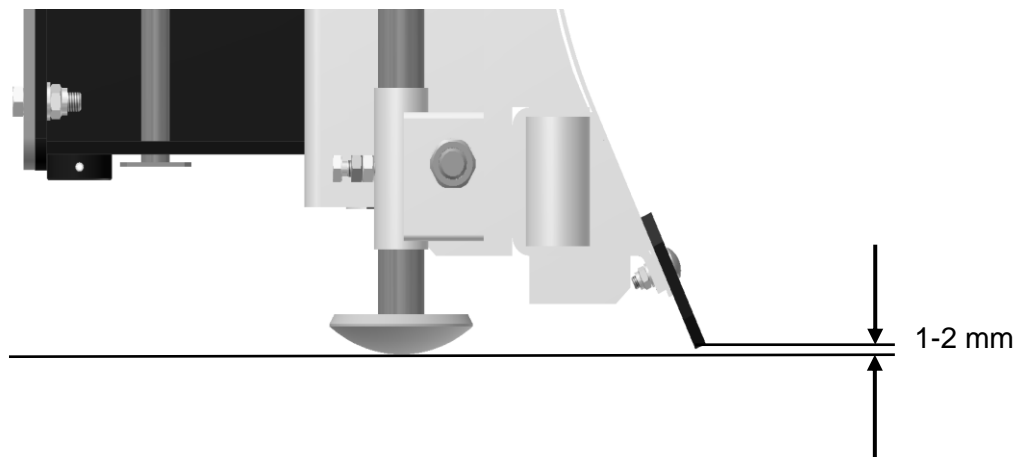

Fig. 2: Adjusting the skids

4 Operation and fault correction

4.1 Operation

If the snow blade is correctly adjusted, you can start working. For travel between implementation sites the snow blade is lifted above the front lift and the lowering safeguard of the front lift is activated. To work with the snow blade it must be lowered and the hydraulic system must be switched to float position.



Danger!
Driving on pressure is prohibited. This can make the vehicle unsteerable!



Attention!
A disabled hydraulic system can result in damage to the implement and/or tractor!

To clear the snow to a specific side the snow blade can be pivoted via the hydraulic angle adjustment on the Quick Hitch. This setting must be made in a slightly lifted out position **without** load on the snow blade. When working with the snow blade small unseen obstacles can be run over. To protect the operator and the implement, the snow blade is equipped with a movable blade plate. When driving against an obstacle (e.g. manhole cover) the blade yields to the front and thus reduces the impact.



Attention!
Danger of crushing due to the blade flipping back.
Never reach into the swing area of the blade when it is tilted forward and the pullback springs are tensioned. Drive in reverse until the blade again rests on the stop!

4.2 Faults

	Possible cause:
After clearing, snow still remains	Skids are adjusted too low
The snow blade vibrates excessively when removing snow	Skid is adjusted too high Extremely uneven substrate
Tractor is hard to steer	Hydraulic system for the front lift is not in float position
The snow blade oscillates back and forth when clearing snow	Hydraulic system for angle adjustment is not in float position Bearings are deflected

4.3 Contact person

If there are faults, problems, or other indications of malfunction, contact your sales consultant or local dealer.

Enter the article number and the chassis number here.

This information is on the type plate of the implement.

Code number:

Serial number:.....



Fig. 3: Nameplate

5 Maintenance

The entire implement must be subjected to regular service.

After first use, the threaded unions on the snow blade must be checked and retightened if necessary. The screws of the scraper bar and the attachment flange are extremely important in this regard.

Daily service:

- Prior to each use, check the safety elements and moving parts for wear.
- Prior to each use, check the adjustment of the skids.
- Clean the implement after each use.
- Check the status of the snow blade, the level of wear on the scraper bar

Maintenance after 25 operating hours (or after a longer standstill period):

At regular intervals, and always at the beginning and end of the season, the moving parts of the implement must be checked. The bearings are maintenance-free and only need to be replaced if there is excessive play.

The most important points are:

- Fold axle of the blade plate
- Skid (wear)

6 Disposal

The snow blade must be disposed of in accordance with the applicable regulations of the municipality or the country. Take the parts to the collection points for residual waste, special waste, or recycle them depending on material.

matev GmbH does not provide any disposal services.

7 Guarantee

The general delivery conditions of matev GmbH apply.

8 Technical data and accessories

Dimensions	Data
Blade width	1500 mm
Blade height	484 mm
Length	308 mm
Weight	49 kg

9 List of illustrations

Fig. 1: Attaching on the Quick Hitch6
Fig. 2: Adjusting the skids.....7
Fig. 3: Nameplate9

