

# HI-SCAN™ 6040-2is

DUAL-VIEW X-RAY INSPECTION FOR HAND LUGGAGE  
EU EDS Cabin Baggage Standard C1 approved



## Feature Highlights

- Compact footprint and weighs less than 850 kg (1873 lbs)
- Steel penetration of 35 mm (1.38")
- Flexible design for easier installation through door widths of 900 mm (35.5")
- Dual-view technology
- Operator friendly interface
- Available in standard and high resolution

**HI-SCAN 6040-2is HR:  
Approved as LEDS according to  
EU Standard 2 and 3 Type C**

**HI-SCAN 6040-2is HR:  
Approved according to EU EDS  
Cabin Baggage Standard C1**

HI-SCAN 6040-2is is an advanced dual view X-ray inspection system for automatic explosives and liquids detection. It offers high throughput at security checkpoints, where bags and personal belongings are screened, utilising proven Heimann X-ray technology to assist with detection of dangerous and illegal objects, highlighted in excellent, high quality dual-view images.

With its modern, contemporary design the HI-SCAN 6040-2is provides increased flexibility, with its compact footprint and lower weight, less than 850 kg (1873 lbs). It can be used in areas that are restricted in space and will fit through doorways of 900 mm (35.5") for installation.

HI-SCAN 6040-2is comes with outstanding steel penetration of 35 mm (1.38") and an operator friendly interface which makes it easy for the user to identify illegal objects and explosives that pose a threat to society.

Available in standard and also in high resolution, for better wire detectability (AWG 40) in order to comply with EU Standard 3 Type C (LEDS).

Another option is iCMORE Weapons for the automatic detection of pistols, revolvers, gun parts, flick and fixed blade knives. Developed using AI, it is part of the iCMORE family of smart and adaptable object recognition algorithms.

The HI-SCAN 6040-2is is suitable for airports, government buildings, hotels and other critical infrastructure applications where reliable security solutions are required.

## General Specifications

<b>Tunnel dimensions</b>	620 (W) x 420 (H) [mm] • 24.4" (W) x 16.5" (H)
<b>Max. object size</b>	615 (W) x 410 (H) [mm] • 24.2" (W) x 16.1" (H)
<b>Conveyor height</b> <sup>1)</sup>	approx. 800 mm (31.4")
<b>Conveyor speed with 50 Hz / 60 Hz</b>	standard: 0.2/0.24 [m/s]
<b>mains frequency</b>	
<b>Max. conveyor load even distributed over the whole conveyor</b> <sup>4)</sup>	160 kg (352 lbs)
<b>Resolution (wire detectability)</b> <sup>2)</sup>	standard resolution (SR): standard: 39 AWG • typical: 40 AWG high resolution (HR): standard: 40 AWG • typical: 41 AWG
<b>Penetration (steel)</b> <sup>2)</sup>	standard: 35 mm • typical: 37 mm
<b>External dose rate</b>	<1 µSv/h (0,1 mrem)
<b>Film safety</b>	guaranteed up to ISO 1600 (33 DIN) with a maximum of 5 inspections
<b>Operating cycle</b>	100 %, no warm-up procedure required

## X-ray Generator

<b>X-ray generators</b>	2
<b>Anode voltage • cooling</b>	160 kV cp • hermetically sealed oil bath
<b>Beam direction</b>	horizontal and vertical

## Image Generating System

<b>X-ray converter</b>	dual-view detector system with large-scale integrated, monolithic amplifier
<b>Grey levels stored</b>	4096
<b>Image presentation</b>	B/W, color, HI-MAT <sup>Plus</sup>
<b>Digital video memory</b>	1280 x 1024 / 24 bit
<b>Image evaluation functions</b>	VARI-MAT, O <sup>2</sup> , OS, HIGH, LOW, NEG, HI-SPOT, SEN, XPlore, Opti-Zoom, HDA, stepless, electronic Zoom: enlargement: up to 64 times
<b>Monitor</b>	Flat Panel LCD Monitor

## Additional Features

<b>Functions</b>	fading-in of date/time, luggage counter, user id-number, luggage marking system (acoustic), display of operating mode, REVIEW-feature (to recall previously visible image areas), zoom overview, free programmable keys, USB 2.0 interface, stepless zoom, IMS (Image Store System - stores up to 100,000 images)
<b>Options</b>	HI-TIP, Random ReCheck, iCMORE Weapons (HR version only)

## Installation Data

<b>X-ray leakage</b>	meets all applicable laws and regulations with respect to X-ray emitting devices
<b>CE labelling/directives</b>	in compliance with directives 2006/42/EC, 2014/35/EU, 2014/30/EU developed in accordance with standards IEC, UN, UL, CSA
<b>Sound pressure</b>	< 65 dB(A)
<b>Operating-/storage temperature</b>	0° - 40°C / -20°C - +60°C
<b>Humidity</b>	10% - 90% (not condensing)
<b>Power supply</b>	standard: 100, 120, 200, 230, 240 VAC +10% / -20% • 50 Hz - 60 Hz ± 3 Hz
<b>Power consumption</b>	max. 1.2 kVA
<b>Protection class system/keyboard</b>	IP 20 / IP 43
<b>Dimensions • weight</b> <sup>3)</sup>	2340 (L) x 1314 (W) x 1372 (H) [mm] • approx. 820 kg
<b>Mechanical construction</b>	steel construction with steel panels, mounted on roller castors standard color(s): silver matt / B11-W1 (blue)

<sup>1)</sup> approx. values (adjustable)

<sup>2)</sup> proprietary quality management test piece: steel step wedge, CU wires, belt speed 0.2 m/s

<sup>3)</sup> without control desk, keyboard, monitor(s) etc.

<sup>4)</sup> measured at ambient temperature of 20°C and nominal voltage

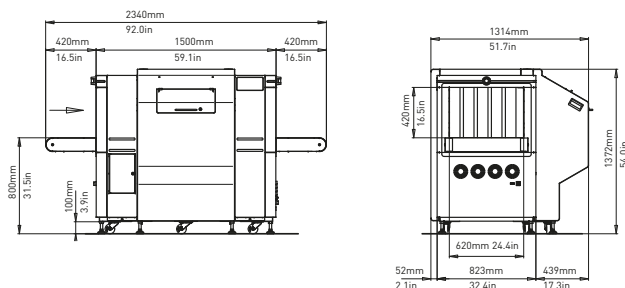

For product information, sales or service, please go to [www.smithsdetection.com/locations](http://www.smithsdetection.com/locations)

Smiths Detection Germany GmbH, Im Herzen 4, 65205 Wiesbaden, Germany  
Modifications reserved. 95594337 25/08/2021 © Smiths Detection Group Ltd. - In some cases, the figures contain options  
HI-SCAN is a trademark of Smiths Detection Group Ltd.