

## Lifting columns

# Two-stage lifting column

Rod-shaped design and extremely quiet operation

### RKSlimlift



#### Highlights / Features:

- Excellent installation height/stroke length ratio
- Self-locking, even at max. load
- Fixing slots in external profile

#### Options:

- Version with manual drive via crank handle
- Further stroke lengths available on request
- Quadro control enables control of up to 32 columns synchron
- Can also be used cable free for mobile adjustment tasks with MultiControl II duo accu

# Table of contents

<b>Versions</b>	<b>Lifting column</b>	RK Slimlift ..... Page 18
<b>Accessories</b>	<b>Fixing</b>	Foot ..... Page 22
		Square nut ..... Page 23
		Profile adaptor ..... Page 23

# Technical data

## General information / operating conditions

Type	RK Slimlift		Custom
Design	Rod-shaped lifting column		
Guide	POM slide bearings		
Installation position	Any position/suspended with drop protection provided by the customer		
Push force	4000 N or 1000 N		
Pull force	2000 N or 500 N		
Self-locking	yes		
Max. travel speed	5 mm/s or 19 mm/s		
Max. stroke	460 mm		750 mm
Installation dimension	610 mm		930 mm
Voltage	36 V DC		
Current output	3,5 A or 4,5 A		
Protection class	IP 30		
Ambient temperature	+5°C to +40°C		
Displacement during synchronous operation	0 to 4 mm		
Duty cycle (Operation mode S3)	At nominal load, 15% (max. 1.5 mins operating time, 8.5 mins rest time)		

### Note:

All information refers to the standard sizes. All data of push/pull forces are referring to the individual lifting column, for combined applications a safety factor of up to 0,6 has to be considered.

## Load data

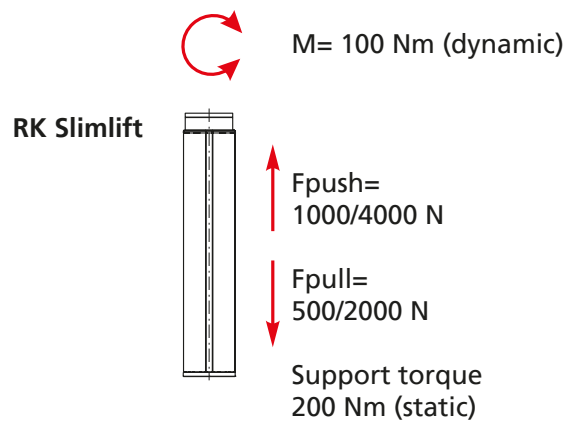

Drive	Push force [N]	Travel speed [mm/s]	Number of assigned motor channels			
			1	2	3	4
RK Slimlift	1000	19	✓	✓	each 500 N	each 300 N
RK Slimlift	4000	5	✓	✓	each 3500 N	each 2000 N
			MultiControl II duo		MultiControl II quadro	

### Note:

If more than 2 drives are to be operated synchronously at nominal load, BUS communication between two or more MultiControl II duo controllers is required.

The necessary accessories can be found on page 172.

The procedure for setting up BUS communication is described in detail in the operating manual.



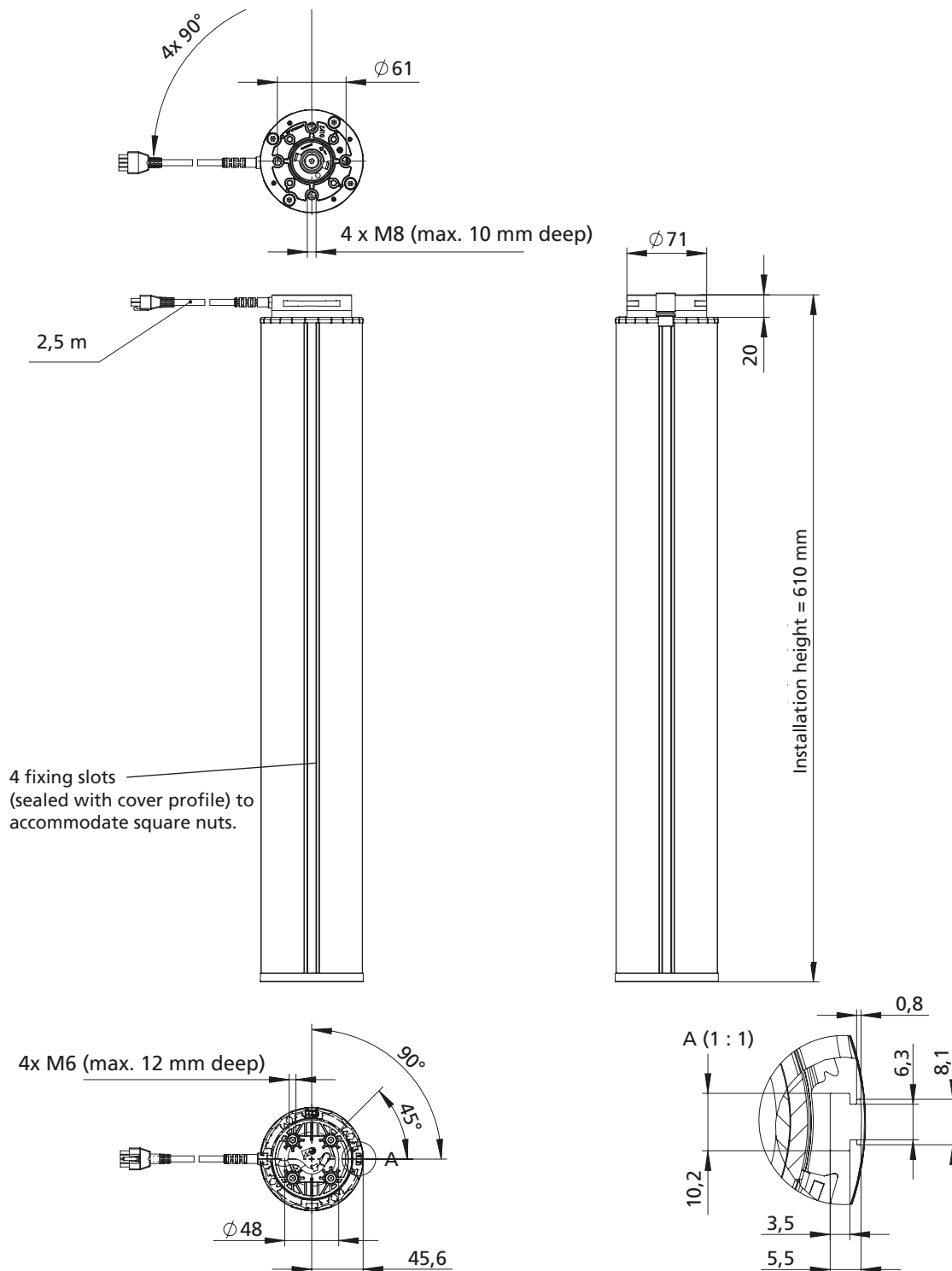

# Versions

## RKSlimlift

The **RKSlimlift** with integrated drive technology delivers high forces and requires a minimum of space. The resultant installation height/stroke length ratio means that short travel times and forces of up to 4000 N can also be achieved. The maximum stroke of the standard catalogue model is 460 mm (customised 700 mm). The slimline design, made from bright anodised extruded aluminium profiles guided by preconfigured plastic slide elements, opens up a wide range of possible combinations for you.

**Special features:**

- Excellent installation height/stroke length ratio
- Attractive design
- Self-locking, even under max. load
- Fixing slots in external profile

**Ideal areas of application:**

- Workplace ergonomics
- Industrial technology
- Media technology

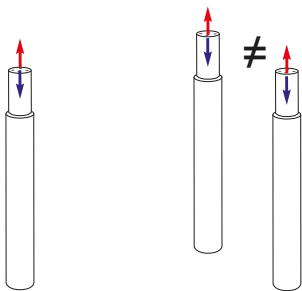

1-2 Slimlifts in single or parallel operation

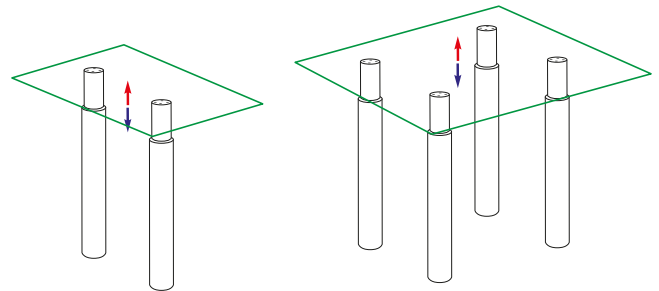

2-4 Slimlifts in synchronous operation

**Parallel operation**

The premium version of the MultiControl II quadro has drive group management. Alongside synchronous and stand-alone operation, this also allows the following drive combinations to run parallel (1+1, 1+2, 2+1, 2+2).

**Synchronous operation**

Synchronous operation of two or more columns. In conjunction with the integrated sensors, the control (see page 156) ensures synchronisation, and thus constant alignment of all the columns in both directions of travel, even if subject to different loads. The synchronous operation tolerance depends on the lifting speed and is max. 1.5 mm for the 5 mm/s version and max. 3 mm for the 19 mm version. A memory function is also available.

## Individual components:

### Lifting column RKSlimlift

Code No.	Type	Push force [N]	Pull force [N]	Lifting speed [mm/s]	Total travel [mm]	Installation dimension [mm]	Weight [kg]
QSL32BA180460	RKSlimlift Eclipse	1000	500	19	460	610	6.0
QSL32BA380460	RKSlimlift Basic	1000	500	19	460	610	6.0
QSL10BD380285	RKSlimlift Basic	4000	2000	5	285	610	7.0

## System components

Code No.	Accessories	
Controls		
QST20H12AA000	MultiControl II duo - Basic	RKSlimlift
QST20H12AA022	MultiControl II duo - Premium	
QST20H14AA000	MultiControl II quadro - Basic	RKSlimlift
QST20H14AA022	MultiControl II quadro - Premium	
Hand switches		
QZB11G07AV041	Hand switch with 6 function keys and display – 1 m cable lenth	
QZB11G07AB041	Hand switch with 2 function keys – 1 m cable lenth	
QZD000074	Hand switch drawer for hand switch with 6 and 2 function keys	
IEC connector		
QZD070618	IEC cable (Europe version, earthed plug)	

#### Note:

Further accessories (hand switches, connecting cables etc.) can be found in the chapter „Controls and accessories“ starting on page 152

## Accessories

### Foot

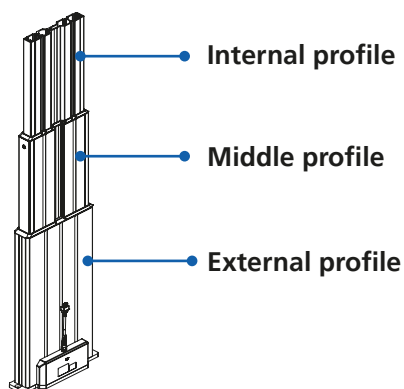

- Both foot versions can be bolted to the external profile without the need for any further modifications

**Material:** GK-ALSi12/3.2583.02, black powder-coating

**Max. load 1000 N**

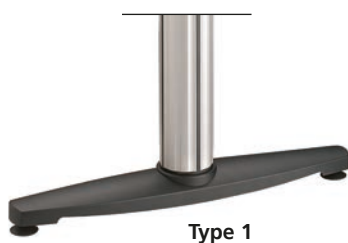

**Type 1**

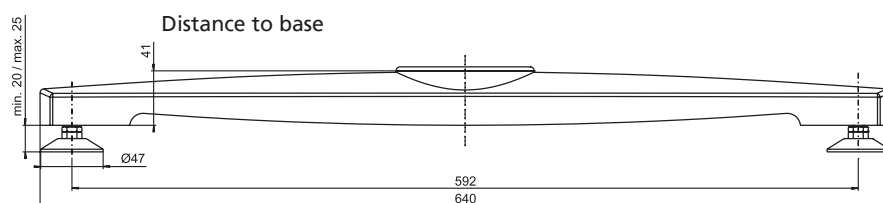

**Type 2**

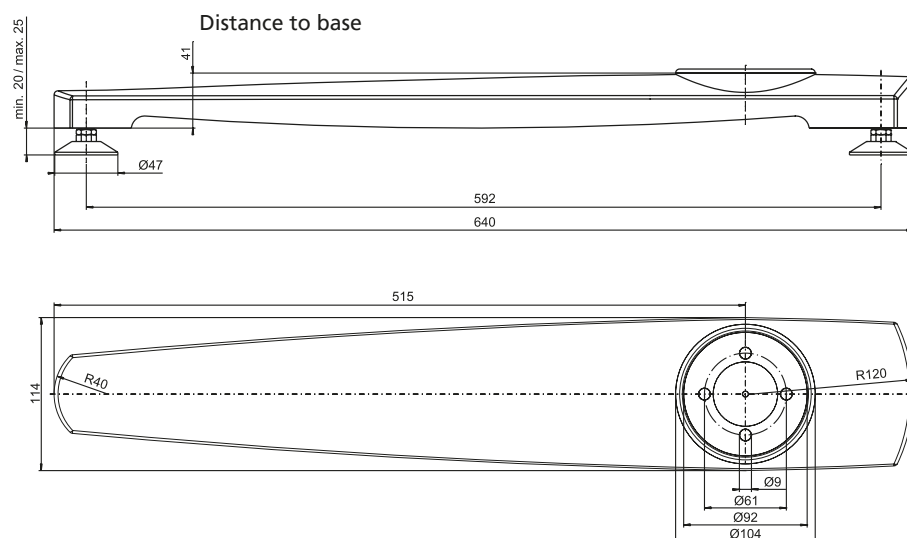

Code No.	Type	Max. load	RK Slimlift	
			Internal profile	External profile
QZD120341	1	1000 N		•
QZD120342	2	1000 N		•

# Fixing

## Square nut



- For connecting accessories to the external profile

**Material:** zinc plated steel

Code No.	lot sizes	Type
QZD0505971	10, 20, 30... pcs	Square nut M6, DIN 562

## Profile adaptor

### Connection example

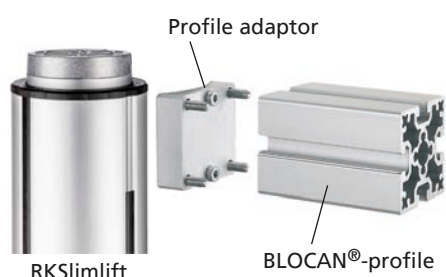

- The profile adaptor allows several lifting columns to be together to form a stable combination. In this way, and with minimum effort, four columns can be connected to form lifting tables and operated via a synchronous control (MultiControl quadro). The aluminium profiles F-60/1, F-60-L, F-G 60, F-2G 60 from the BLOCAN® Profile Assembly System are suitable as struts for this purpose.

**Material:** AlMgSi, clear anodised zinc plated fastenings

**Scope of delivery:** one profile adaptor with fastenings for attachment to one end of the profile

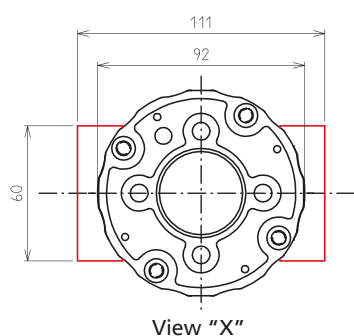
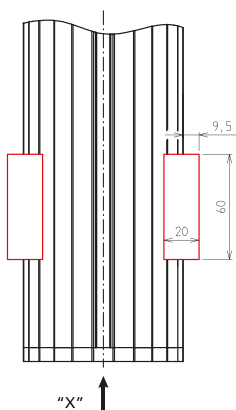

Code No.	Type	RK Slimlift	
		Internal profile	External profile
QZD120256	Complete profile adaptor		•

### Application example:

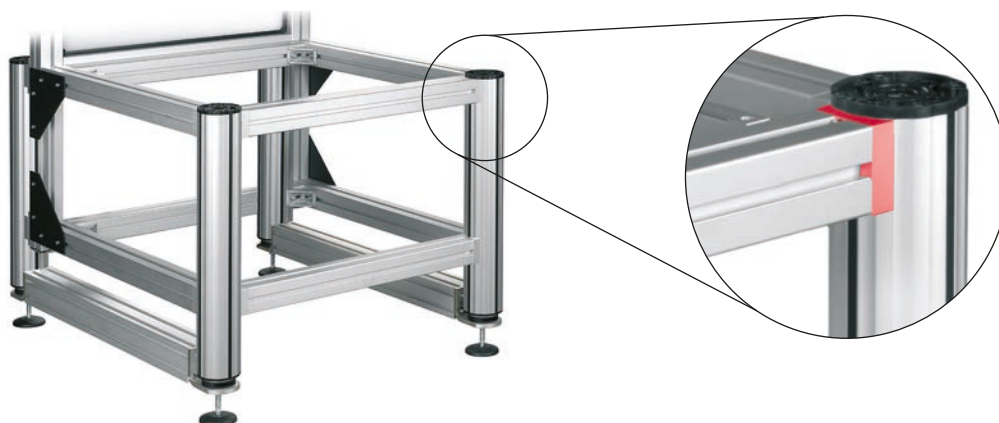



# Fixing

## Fixing plate



- This universal plate can be bolted directly into the screw channel of the lifting column using a fixing set. The numerous pre-drilled holes in the metal make it easy to attach table tops, brackets, etc.

**Material:** steel, black powder-coated (RAL 9005), zinc plated fastenings

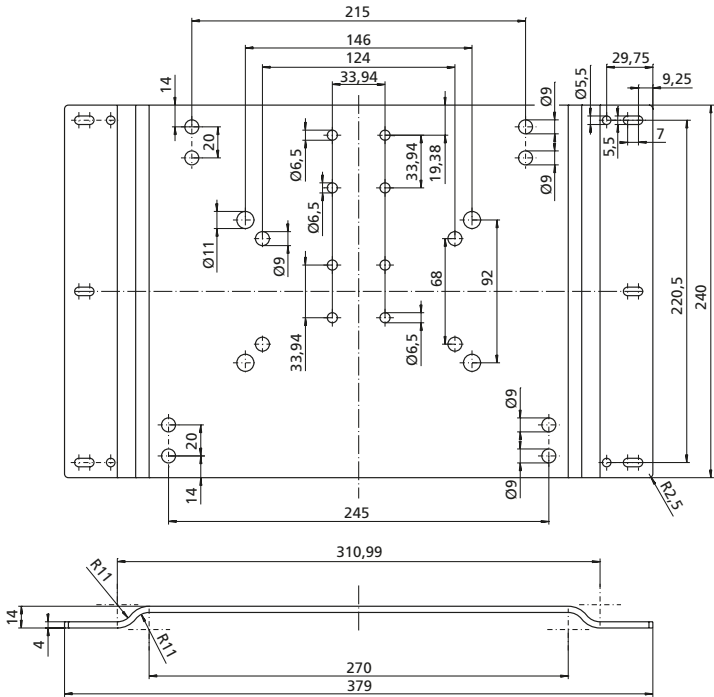
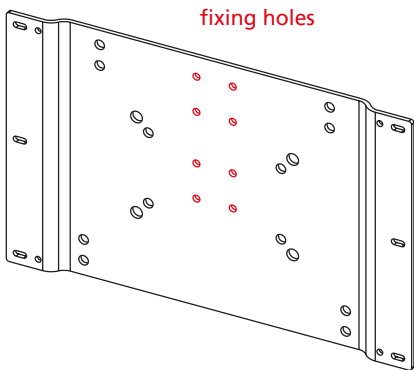

Code No.	Version	RK Slimlift	
		Internal profile	External profile
QZD100313	Fixing plate	•	
QZD120336	Fixing set, 4x M6 x 14, DIN 7984		



## Two-stage lifting column

Rod-shaped design and extremely quiet operation

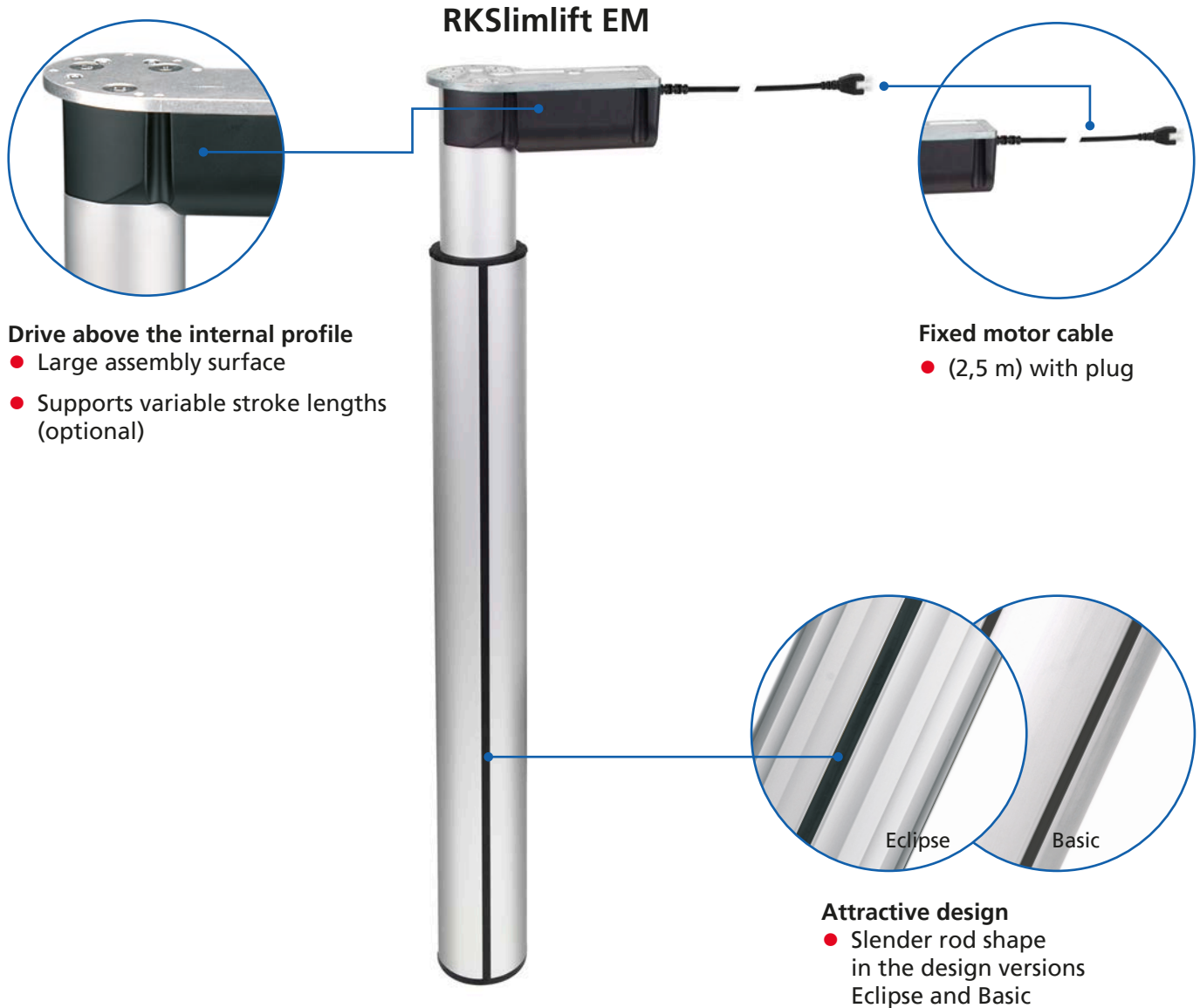

### Highlights / Features:

- Excellent installation height/stroke length ratio
- Self-locking, even at max. load
- Fixing slots in external profile

### Optionen:

- Version with manual drive via crank handle
- Further stroke lengths available on request
- Quadro control enables control of up to 32 columns synchron
- Can also be used cable free for mobile adjustment tasks with MultiControl II duo accu

# Table of contents

## Lifting column

<b>Versions</b>	RK Slimlift EM.....	Page 28
-----------------	---------------------	---------

## Accessories

<b>Fixing</b>	Foot .....	Page 32
	Square nut .....	Page 33
	Profile adaptor .....	Page 33

# Technical data

## General information / operating conditions

Type	RK Slimlift EM		Custom
Design	Rod-shaped lifting column		
Guide	POM slide bearings		
Installation position	Any position / suspended with drop protection provided by the customer		
Push force	1000 N		
Pull force	1000 N		
Self-locking	yes		
Max. travel speed	15 mm/s		
Max. stroke	500 mm		750 mm
Installation dimension	Stroke + 180 mm		930 mm
Voltage	36 V DC		
Current output	3,5 A		
Protection class	IP 30		
Ambient temperature	+5°C to +40°C		
Displacement during synchronous operation	0 to 4 mm		
Duty cycle (Operation mode S3)	At nominal load, 15% (max. 1.5 mins operating time, 8.5 mins rest time)		

### Note:

All information refers to the standard sizes. All data of push/pull forces are referring to the individual lifting column, for combined applications a safety factor of up to 0,6 has to be considered.

## Load data

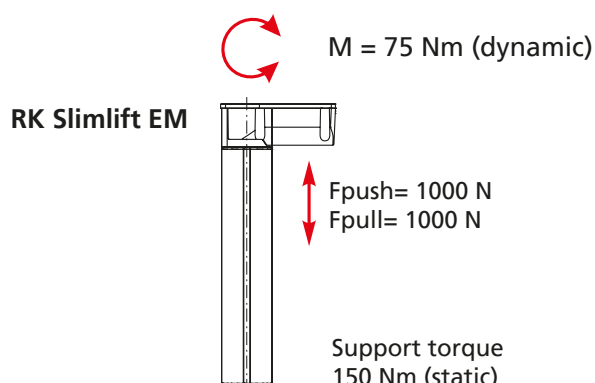

Drive	Push force [N]	Travel speed [mm/s]	Number of assigned motor channels			
			1	2	3	4
RK Slimlift EM	1000	15	✓	✓	each 900 N	each 600 N
			MultiControl II duo		MultiControl II quadro	

### Note:

If more than 2 drives are to be operated synchronously at nominal load, BUS communication between two or more MultiControl II duo controllers is required.

The necessary accessories can be found on page 172.

The procedure for setting up BUS communication is described in detail in the operating manual.





**RK ROSE+KRIEGER**

Introduction

Areas of application

Lifting columns

Electric cylinder

Controls & Accessories

Appendix

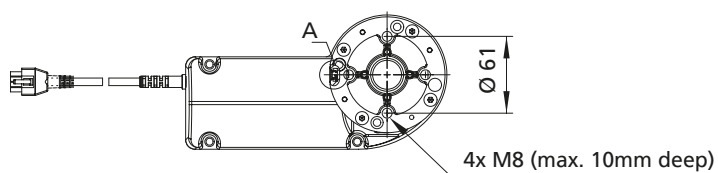
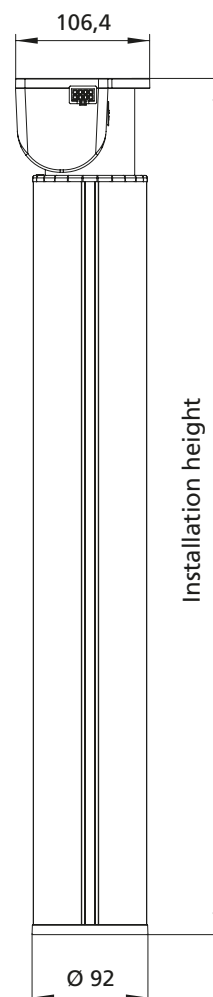
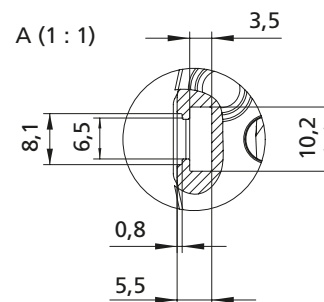
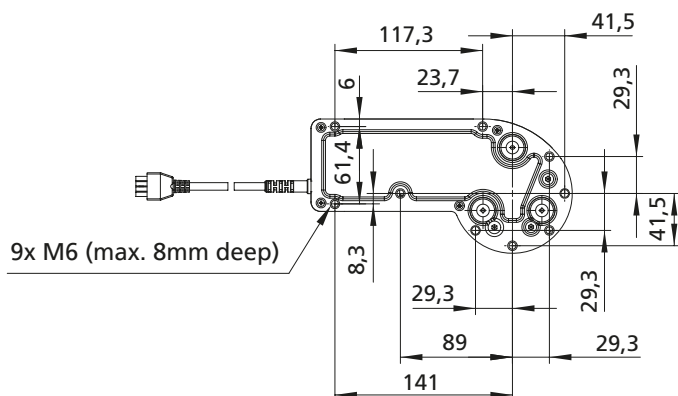

## Versions

### RK Slimlift EM

Based on the tried-and-tested **RK Slimlift** lifting column a further version has been developed. On the **RK Slimlift EM** the motor/gear unit is installed above the inner profile and is used simultaneously as a mounting surface for table frames screwed in place from above or table tops screwed in place from below, for instance. With a compressive force of 1000 N the **RK Slimlift EM** achieves 15 mm/s and absorbs side torques of an impressive 150 Nm. The standard installation dimension is 610 mm, with a stroke of up to 500 mm (Custom 750 mm) being possible.



#### Special features:

- Excellent installation height/stroke length ratio
- Attractive design
- Self-locking, even under max. load
- Fixing slots in external profile

#### Ideal areas of application:

- Workplace ergonomics
- Industrial technology
- Media technology

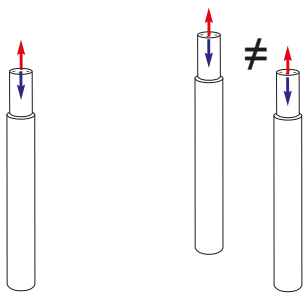

1-2 Slimlifts in single or parallel operation

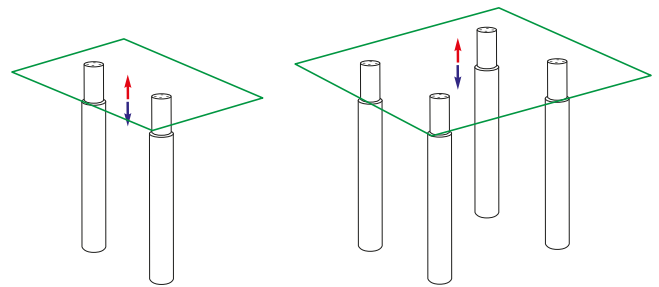

2-4 Slimlifts in synchronous operation

### Parallel operation

The premium version of the MultiControl II quadro has drive group management. Alongside synchronous and stand-alone operation, this also allows the following drive combinations to run parallel (1+1, 1+2, 2+1, 2+2).

### Synchronous operation

Synchronous operation of two or more columns. In conjunction with the integrated sensors, the control (see page 156) ensures synchronisation, and thus constant alignment of all the columns in both directions of travel, even if subject to different loads. The synchronous operation tolerance depends on the lifting speed and is max. 1.5 mm for the 8 mm/s version. A memory function is also available.

## Individual components:

### Lifting column RKSlimlift EM

Code No.	Type	Push force [N]	Pull force [N]	Lifting speed [mm/s]	Total travel [mm]	Installation dimension [mm]	Weight [kg]
QSL25BA290300	RKSlimlift EM Basic	1000	1000	15	300	480	~4.5
QSL25BA190300	RKSlimlift EM Eclipse	1000	1000	15	300	480	~4.5
QSL25BA290400	RKSlimlift EM Basic	1000	1000	15	400	580	~5.3
QSL25BA190400	RKSlimlift EM Eclipse	1000	1000	15	400	580	~5.3
QSL25BA290430	RKSlimlift EM Basic	1000	1000	15	430	610	~5.5
QSL25BA190430	RKSlimlift EM Eclipse	1000	1000	15	430	610	~5.5
QSL25BA290500	RKSlimlift EM Basic	1000	1000	15	500	680	~6.0
QSL25BA190500	RKSlimlift EM Eclipse	1000	1000	15	500	680	~6.0

## System components

Code No.	Accessories	
Controls		
QST20H12AA000	MultiControl II duo - Basic	RKSlimplift EM
QST20H12AA022	MultiControl II duo - Premium	
QST20H14AA000	MultiControl II quadro - Basic	RKSlimplift EM
QST20H14AA022	MultiControl II quadro - Premium	
Hand switches		
QZB11G07AV041	Hand switch with 6 function keys and display – 1 m cable lenth	
QZB11G07AB041	Hand switch with 2 function keys – 1 m cable lenth	
QZD000074	Hand switch drawer for hand switch with 6 and 2 function keys	
IEC connector		
QZD070618	IEC cable (Europe version, earthed plug)	

### Note:

Further accessories (hand switches, connecting cables etc.) can be found in the chapter „Controls and accessories“ starting on page 130



## Accessories

### Foot

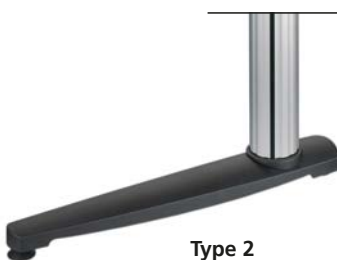
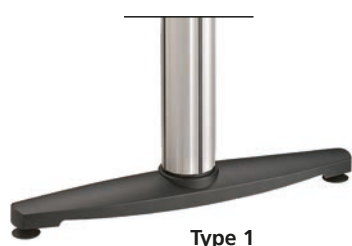
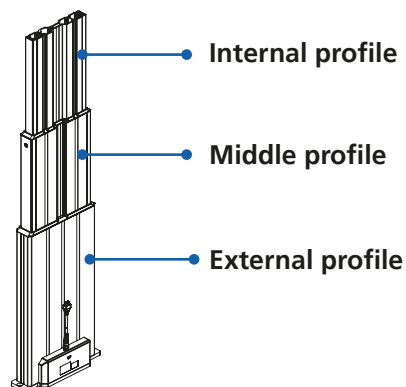

- Both foot versions can be bolted to the external profile without the need for any further modifications

**Material:** GK-ALSi12/3.2583.02, black powder-coating

**Max. load 1000 N**

#### Type 1

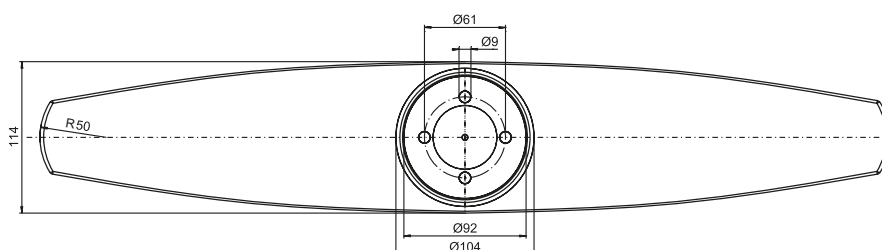
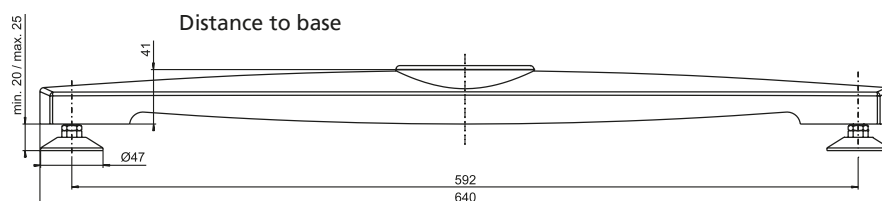

#### Type 2

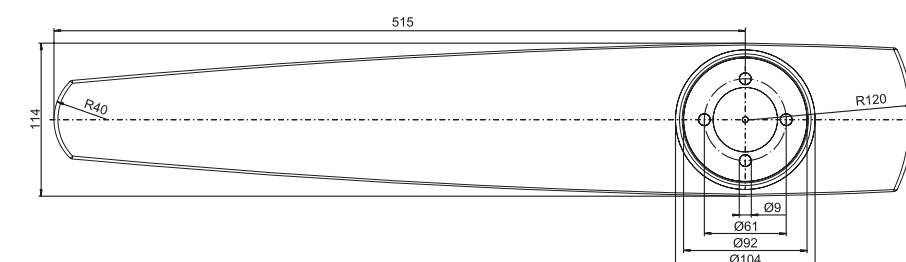
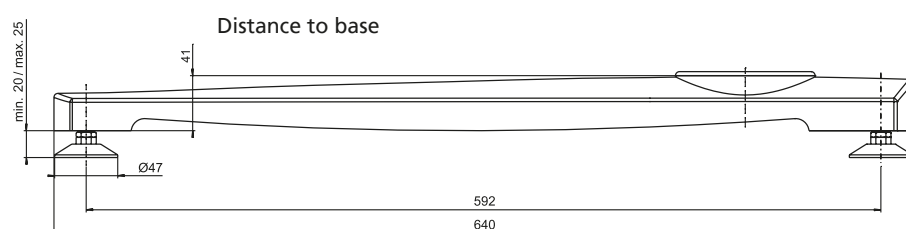

Code No.	Type	Max. load	RK Slimlift EM	
			Internal profile	External profile
QZD120341	1	1000 N		•
QZD120342	2	1000 N		•

### Levelling foot (for Type EM)

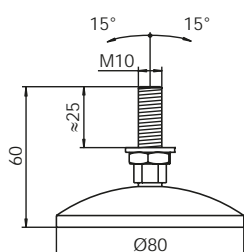

- The foot can be bolted centrally into the base plate of the RK Slimlift EM.
- Max. screw-in depth 25 mm

**Material:** steel parts zinc plated  
Pivot plate PA, black



Code No.	Type	RK Slimlift EM	
		Internal profile	External profile
QZD120340	Levelling foot		•

# Fixing

## Square nut



- For connecting accessories to the external profile

**Material:** zinc plated steel

Code No.	lot sizes	Type
QZD0505971	10, 20, 30... pcs	Square nut M6, DIN 562

## Profile adaptor

### Connection example

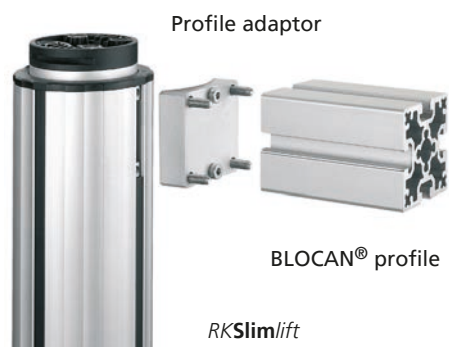

- The profile adaptor allows several lifting columns to be together to form a stable combination. In this way, and with minimum effort, four columns can be connected to form lifting tables and operated via a synchronous control (Multi-Control II quadro). The aluminium profiles F-60/1, F-60-L, F-G 60, F-2G 60 from the BLOCAN® Profile Assembly System are suitable as struts for this purpose.

**Material:** AlMgSi, clear anodised Galvanised fastenings

**Scope of delivery:** one profile adaptor with fastenings for attachment to one end of the profile

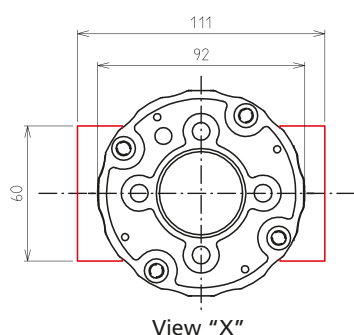
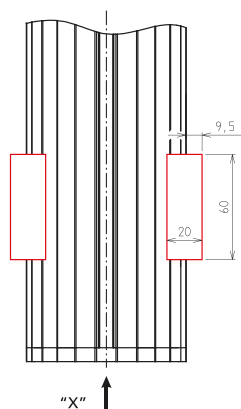

Code No.	Type	RK Slimlift EM	
		Internal profile	External profile
QZD120256	Complete profile adaptor		•

### Application example:

