

# FLENDER Standard Couplings

## Flexible Couplings – N-EUPEX and N-EUPEX DS Series

Type B

## Selection and ordering data

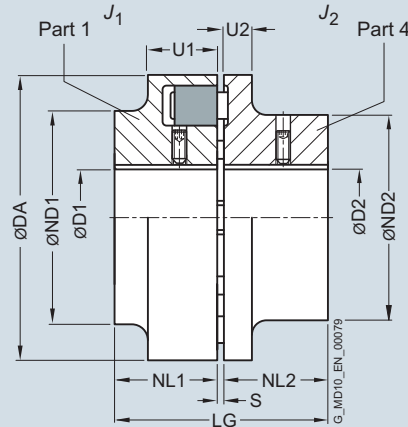

Size	Rated torque flexible type 80 ShoreA $T_{KN}$ Nm	Speed $n_{Kmax}$ rpm	Dimensions in mm											Mass moment of inertia $J_1/J_2$ kgm <sup>2</sup>	Article No. Order codes for bore diameters and tolerances are specified in catalog section 3	Weight $m$ kg									
			Bore with keyway to DIN 6885		D1		D2		DA		ND1		ND2				NL1/ S NL2		U1		U2		LG		
			min.	max.	min.	max.	min.	max.	min.	max.	min.	max.	min.	max.	min.	max.	min.	max.	min.	max.	min.	max.			
58	19	7500	-	19	-	24	58	58	40	20	3	20	8	43	0.0001	<b>2LC0100-0AA</b> ■ ■ ■ -0AA0	0.4								
68	34	7000	-	24	-	28	68	68	50	20	3	20	8	43	0.0002	<b>2LC0100-1AA</b> ■ ■ ■ -0AA0	0.54								
80	60	6000	-	30	-	38	80	80	68	30	3	30	10	63	0.0006	<b>2LC0100-2AA</b> ■ ■ ■ -0AA0	1.3								
95	100	5500	-	42	-	42	95	76	76	35	3	30	12	73	0.0013	<b>2LC0100-3AA</b> ■ ■ ■ -0AA0	2.2								
110	160	5300	-	48	-	48	110	86	86	40	3	34	14	83	0.003	<b>2LC0100-4AA</b> ■ ■ ■ -0AA0	3.3								
125	240	5100	-	55	-	55	125	100	100	50	3	36	18	103	0.006	<b>2LC0100-5AA</b> ■ ■ ■ -0AA0	5.2								
140	360	4900	-	60	-	60	140	100	100	55	3	34	20	113	0.007	<b>2LC0100-6AA</b> ■ ■ ■ -0AA0	5.6								
160	560	4250	-	65	-	65	160	108	108	60	4	39	20	124	0.01	<b>2LC0100-7AA</b> ■ ■ ■ -0AA0	7.8								
180	880	3800	-	75	-	75	180	125	125	70	4	42	20	144	0.02	<b>2LC0100-8AA</b> ■ ■ ■ -0AA0	11.5								
200	1340	3400	-	85	-	85	200	140	140	80	4	47	24	164	0.04	<b>2LC0101-0AA</b> ■ ■ ■ -0AA0	16								
225	2000	3000	-	90	-	90	225	150	150	90	4	52	18	184	0.07	<b>2LC0101-1AA</b> ■ ■ ■ -0AA0	20								
250	2800	2750	46	100	46	100	250	165	165	100	5.5	60	18	205.5	0.12	<b>2LC0101-2AA</b> ■ ■ ■ -0AA0	29								
280	3900	2450	49	110	54	110	280	180	180	110	5.5	65	20	225.5	0.18	<b>2LC0101-3AA</b> ■ ■ ■ -0AA0	38								
ØD1:																1									
• Without finished bore – Without order codes																9									
• With finished bore – With order codes for diameter and tolerance (article number without "-Z")																9									
ØD2:																1									
• Without finished bore – Without order codes																9									
• With finished bore – With order codes for diameter and tolerance (article number without "-Z")																9									

Weights and mass moments of inertia apply to maximum bore diameters.

## Ordering example:

N-EUPEX B coupling, size 95,

Part 1: Bore D1 42H7 mm, keyway to DIN 6885-1 and set screw,

Part 2: Bore D2 32H7 mm, keyway to DIN 6885-1 and set screw.

Article No.:

**2LC0100-3AA99-0AA0**

**LOX+M0T**

The article number applies to standard flexibles of 80 ShoreA; the article number for alternative flexible types is available on request.