

Specification

DELOLUX 50 base unit

Order no. 95 200 50

General details

Dimensions (W x D x H)	142 x 275 x 128 mm
Weight	2.1 kg
Voltage / frequency	100 – 240 V / 50 – 60 Hz
Power consumption	max. 60 W
Material of housing	aluminum
Certificates and safety standards	RoHS-compliant, CE-certified

Interfaces

PLC input/output signal	Input: optocoupler inputs Low level: 0 – 1 V High level: 5 – 24 V Output: open collector optocoupler output, max. 24 V, 30 mA (emitter on GND)
PLC input/output type	25-pole SUB-D socket on the rear of the device
Input/output channel DELO-UNIPRO	connection to DELO-UNIPRO
Channel DELO-UNIPRO	37-pole SUB-D socket on the rear of the device
RS 232 interface	programming interface for software updates
RS 232 interface type	9-pole SUB-D socket on the rear of the device

Environmental conditions

Operating temperature	+15 °C to +45 °C
Relative humidity during operation	max. 80 %, not condensing
Safety classification	1
Safety type	IP 20
Storage temperature	-30 °C to +60 °C
Relative humidity during storage	max. 90 %, not condensing

Specification

DELOLUX 50 base unit

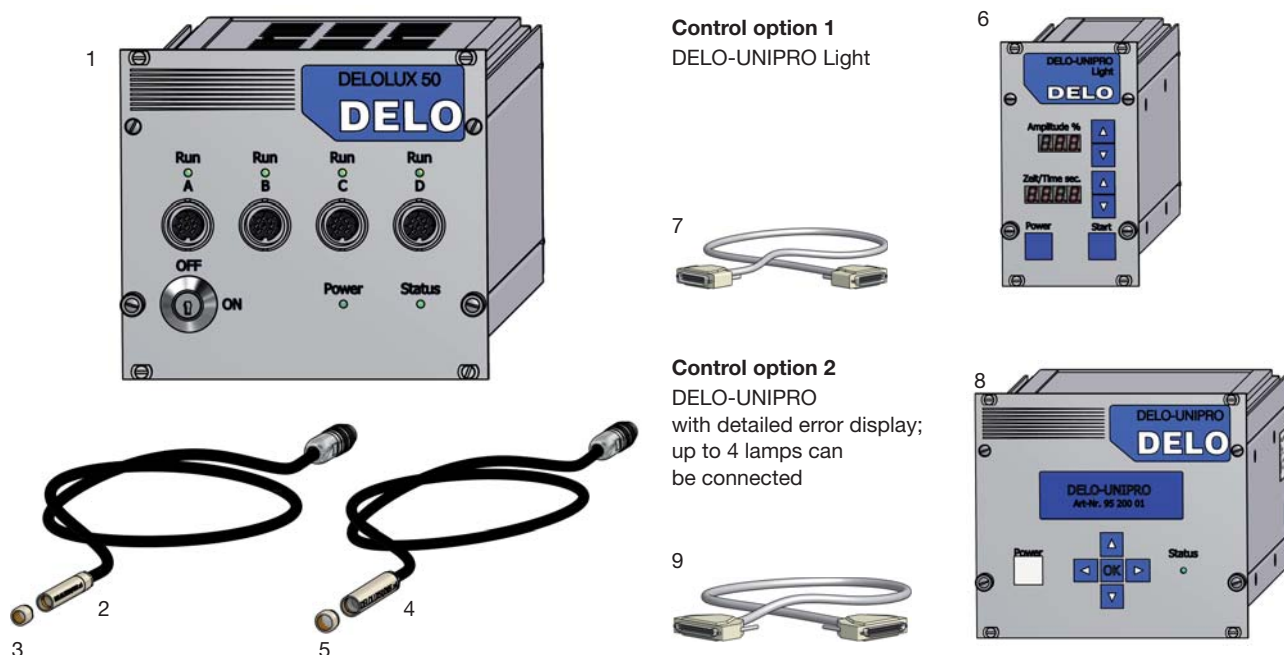

Control option 1
DELO-UNIPRO Light

Control option 2
DELO-UNIPRO
with detailed error display;
up to 4 lamps can
be connected

No.	Order no.	Designation	Description
1	95 200 50	DELOLUX 50 base unit	Spot light source base unit for up to 4 LED heads (without LED head)
2	95 200 69	DELOLUX 50 LED head 365 x1	Lamp head (without lens) with 1 LED for connection to DELOLUX 50, emitted wavelength: 365 nm; length of cable 1.5 m
2	95 200 65	DELOLUX 50 LED head 400 x1	Lamp head (without lens) with 1 LED for connection to DELOLUX 50, emitted wavelength: 400 nm; length of cable 1.5 m
2	95 200 68	DELOLUX 50 LED head 460 x1	Lamp head (without lens) with 1 LED for connection to DELOLUX 50, emitted wavelength: 460 nm; length of cable 1.5 m
3	95 200 94	Lens L1 for DELOLUX 50 x1	Interchangeable lens L1 for LED head DELOLUX 50 x1, optimized for areas up to 1 mm dia., working distance 3 – 5 mm
3	95 200 95	Lens L2 for DELOLUX 50 x1	Interchangeable lens L2 for LED head DELOLUX 50 x1, optimized for areas up to 2 mm dia., working distance 6 – 14 mm
3	95 200 96	Lens L3 for DELOLUX 50 x1	Interchangeable lens L3 for LED head DELOLUX 50 x1, optimized for areas up to 3 mm dia., working distance 8 – 14 mm
3	95 200 97	Lens L6 for DELOLUX 50 x1	Interchangeable lens L6 for LED head DELOLUX 50 x1, optimized for areas up to 6 mm dia., working distance 10 – 30 mm
4	95 200 70	DELOLUX 50 LED head 365 x4	Lamp head (without lens) with 4 LEDs for connection to DELOLUX 50, emitted wavelength: 365 nm; length of cable 1.5 m
5	95 200 86	Lens L5 for DELOLUX 50 x4	Interchangeable lens L5 for LED head DELOLUX 50 x4, optimized for intensive irradiation of areas up to 5 mm dia., working distance 7 – 8 mm
5	95 200 87	Lens L10 für DELOLUX 50 x4	Interchangeable lens L10 for LED head DELOLUX 50 x4, optimized for intensive irradiation of areas up to 10 mm dia., working distance 10 – 15 mm
6	95 200 51	DELO-UNIPRO Light	Control unit for DELOLUX LED lamps; for adjusting intensity and irradiation time
7	95 200 53	Connection line; DELOLUX 50, 20, 202 – DELO-UNIPRO Light	Connection line between DELOLUX 50 and DELO-UNIPRO Light, length: 2 m
8	95 200 01	DELO-UNIPRO	Control unit for DELOLUX LED lamps with detailed error display; up to 4 lamps can be connected
9	95 200 59	Connection line; DELOLUX 20, 202, 50, 80 – DELO-UNIPRO	Connection line between DELOLUX 50 and DELO-UNIPRO, length: 2 m
	95 200 36	DELO-RACK for DELOLUX 50, 20, 202 and DELO-UNIPRO Light	Gehäuse zur Aufnahme je einer DELOLUX 50 und eines DELO-UNIPRO Light
	91 910 01	Foot switch	Foot switch to trigger irradiation; length of cable: 2 m
	95 200 43	UV safety glasses	Glasses to protect the eyes against UV radiation

→ You can find further information in the operating instructions