



IL ROBOT DI VERNICIATURA RAPIDO E COMPATTO

Robot antropomorfo con sei gradi di libertà adatto alle verniciature di pezzi di medie e piccole dimensioni. La caratteristica principale risiede nella struttura compatta e nell'alta velocità di esecuzione. Questo robot è ideale per la programmazione offline e con il sistema punto a punto. La capacità di carico di questo robot di verniciatura è di 10 Kg e prevede un'area di lavoro di 2.000 mm.

- ECONOMICO
- VELOCE
- COMPATTO
- GRANDE CAPACITÀ DI CARICO

FAST AND COMPACT PAINTING ROBOT

Anthropomorphic robot with six degrees of freedom suitable for painting small and medium sized pieces. The main feature are a compact structure and high speed of execution. This robot is ideal for offline and point-to-point programming. The payload of this painting robot is 10 kg and has a working area of 2,000 mm.

- ECONOMIC
- FAST
- COMPACT
- LARGE LOAD CAPACITY

www.cmarobotics.com



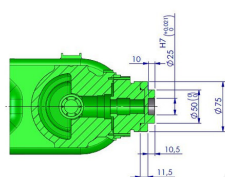
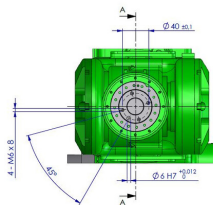
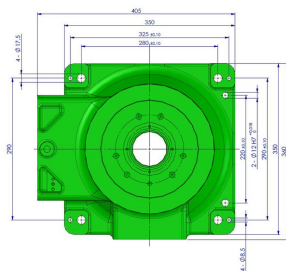
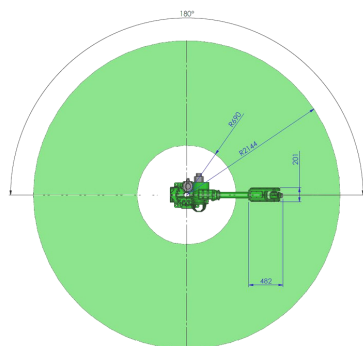
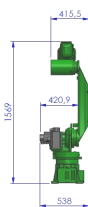
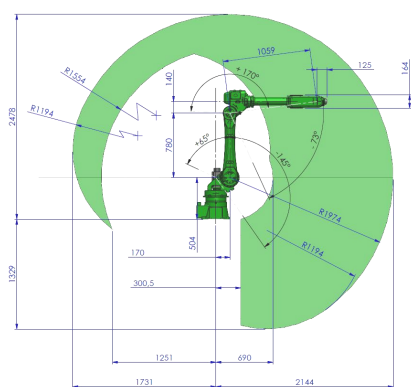

DATI TECNICI

Robot model	GR610ST	
Payload	10 kg	
Axis	6	
Range of motion	J1	+/-180
	J2	+65°/-145°
	J3	+170°/-73°
	J4	+/-180°
	J5	+/-135°
	J6	+/-360
Max. Speed	J1	170°/s
	J2	165°/s
	J3	170°/s
	J4	360°/s
	J5	360°/s
	J6	600°/s
Wrist allowable torque	J4	24.5 Nm
	J5	24.5 Nm
	J6	12 Nm

Driving power	Motor	AC servo motor
	Total Power	3 kW
	Working Voltage	400V
Brake	J1-J6	
Position repeat accuracy	0.06 mm	
Max. working radius	2019 mm	
Weight	221 kg	
Atex	No	
Robot IP-Class	IP65	
Cabinet IP-Class	IP52	
Installation	Floor/Ceiling	
Operating temperature	0°C/+40°C	
Storage temperature	0°C/+55°C	
Air supply (Pressure)	At least 7 bar (0.6MPa)	
Air (Flow)	> 50 Nl/min.	
Air precision requirements	<5µm	
Robot control box size	L1000*H1100*D500 mm	
Robot control box weight	185kg	