



**Tightening automation.**  
Only excellent solutions.



**RSEP air screwdrivers**  
with semi-automatic screw loading

- Tightening torque: from 1,5 to 8 Nm
- Slip clutch

**Fiam**<sup>®</sup>  
PEOPLE AND SOLUTIONS

**RSEP air screwdrivers  
with semi-automatic screw loading**

# RSEP: versatile, accurate, safe and fast

RSEP air screwdrivers with semi-automatic screw loading are widely used in the assembly of wood, plastic and metal furniture, fittings, domestic appliances, etc., especially when using **self-threading or self-drilling** screws.

Drilling and assembly operations are **accurate, safe,** and above all, **fast:** the screw, loaded through the funnel, is held firmly by the clamps and can be driven easily in any position without being guided by the operator.

Be demanding

## Reliability

Long lifetime of the components thanks to careful design and to quality of the productive process which results in less maintenance and repair costs

The internal gears guarantee **lasting performances** and **long life** of the screwdriver

The air motors employed ensure **long lifetime, high power and maximum output**

Control of the tightening torque is ensured by the **Uni-Jointech torque control system** (slip clutch): it is up to the operator to decide when to stop the tightening process

Tools are manufactured with high quality materials that **guarantee greater resistance to wear**



Manual screw loading



Semi-automatic (manual) loading of screw on screwdriver bit



The screw is loaded



Positioning of the screw in the driving area

3.5"

Don't be satisfied  
with the maximum

## Productivity

Considerable increase of the efficiency of the productive cycle thanks to innovative systems

This **extremely versatile** air screwdriver can be used with **screws of different diameters and lengths** in a wide range of applications

RSEP air screwdrivers are widely used in the assembly of wood, plastic and metal furniture, fittings, domestic appliances, etc., especially when using **self-threading or self-drilling screws**

**Drilling and assembly operations are accurate, safe,** and above all, **fast:** the screw, loaded through the funnel, is held firmly by the clamps and can be driven easily in any position without being guided by the operator



Perfection  
is in your hands

## Ergonomics

Optimization of the tool performances in regard to ergonomics and operator safety

The **low weight** and the **ergonomic grip** make it easier to hold the screwdriver, improving the handling and operator's comfort

The **practical hanging ring** allows optimum tool balance and easier handling

The new **reduced-effort starting button** guarantees greater comfort for the operator

The grip is designed to be used **both by right and left hand operators**

**Possibility to convey the air exhaust** in a practical and fast way

The **silencing system** and the **controlled diffusion of the exhaust air flow** allow to reduce the noise level

Naturally  
innovative

## Ecology

Innovative systems designed paying even more attention with respect to environment and of its safeguard

The technological design of the air motor permits **high decrease of air consumption**, without affecting tool performances

The design of the inner kinematic motions **optimizes the output of the available power**, which is being transmitted with minimum dispersions

All the components are **easy to dispose** of because they are built **using recyclable materials**; therefore they won't be an environmental pollution and/or personal safety hazard

All Fiam products are supplied with **eco-friendly packaging**

The possibility of using non lubricated air **eliminates the emission of oil fog** into the environment



Suitable for  
tightening operations  
in "difficult" positions

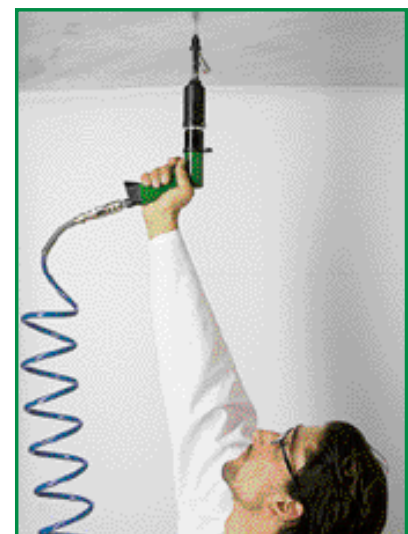

Type of screwdriver	Models	Code	Grip	Tightening torque on soft joint				Idle speed	Starting system	Reversibility	Weight	Dimensions (mm)	Air consumption	Accessories	Noise level
				Type	Nm min.	Nm max.	in lb min.								
	RSEP7 ①	114671524		1,5 ÷ 7	13.275-61.95	2600			1,100	2.42	41x330x155	9	FThr - M5	77	
	RSEP8 ②	114671525		2 ÷ 8	17.7-70.8	1800			1,100	2.42	41x330x155	9	FThr - M5	77	

### Legend



**Reversibility:** All models are suitable for tightening operations



**Push button**

① Air screwdriver for use with cross slot screws. Screw head diameter must not to exceed 7 mm with a total maximum length of 35 mm (see list of Accessories available upon request).

② Air screwdriver for use with cross slot screws. Screw head diameter must not to exceed 8.2 mm with a total maximum length of 35 mm (see list of Accessories available upon request).

- The figures shown are measured at a pressure of 6,3 bar (ISO 2787), the recommended operating pressure
- The tightening torque values have been measured in accordance with ISO 5393 standard
- Noise level has been measured in accordance with ISO 3744 and ISO 15744 standards
- The code number must be used when ordering

The data given in the table are indicative and can be changed without prior notice. The torque values are purely indicative and may be influenced by the softness of the type of joint, by the type and length of the screw, by the pressure and quantity of air supply, and by the type of accessory used. The values indicated for noise levels were obtained in the laboratory, performing tests that comply with the standards stated, but alone are not sufficient for calculating risks. Values measured in the single work places may be higher than those stated. The values of actual exposure and consequent risks are specific and depend on the operator's method of work, the type of work piece and the work place, as well as the operator's time of exposure and his physical conditions.

Fiam cannot be held responsible for any consequences deriving from the use of the information in the table when evaluating risks in the work place over which Fiam has no control. For all further details, please apply to the Fiam Technical Consultancy Service.



**RSEP screwdrivers are designed for use with either lubricated or unlubricated compressed air**

### Other technical features

Models	Air inlet	Recommended hose bore
RSEP..	1/4" gas	Ø 8 mm

### Standard equipment (supplied with the tool)

- Clutch adjustment key
- Additional clutch spring
- Hanging ring
- Use and maintenance manual
- Eco-friendly packaging

### Accessories available upon request

- Balancers, conveyors and other compressed air system accessories (see Accessories Catalogue).
- Bits for cross slot screw

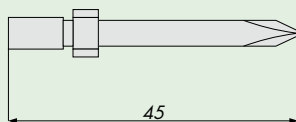

Slot nr.x	Phillips code	Pozidrive code
1	635051001	635061001
2	635051002	635061002