

O-I GLASSPACK GmbH & co. KG

Goethestrasse 75
 40237 Düsseldorf, Germany
 Tel. +49 0211/2809-0
 +49 0211/832-0

CONTAINER & MOULD ENGINEERING
EUROPE

NOTES:
 THIS DRAWING IS THE PROPERTY OF O-I AND
 MUST NOT BE REPRODUCED OR DISCLOSED
 WITHOUT O-I WRITTEN AUTHORIZATION.

ONLY TOLERANCED DIMENSIONS ARE GUARANTEED.

MANUFACTURING MARKINGS SHOWN ARE FOR ILLUSTRATIVE
 PURPOSES ONLY, ACTUAL MARKINGS ON CONTAINER
 MAY DIFFER, DEPENDANT ON LOCAL LEGISLATION.

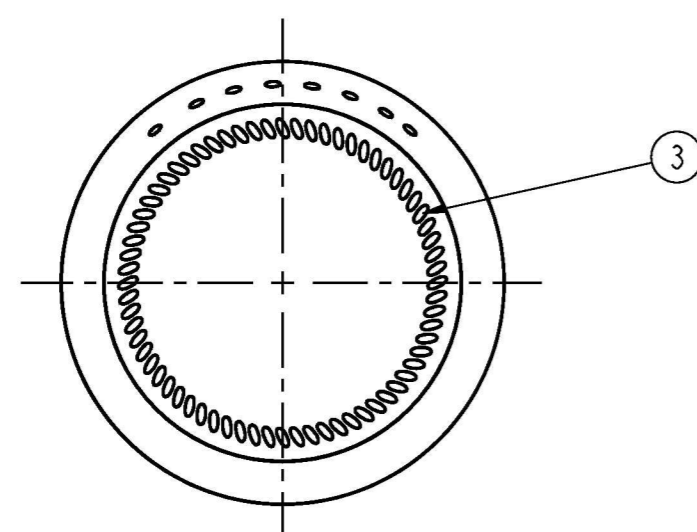
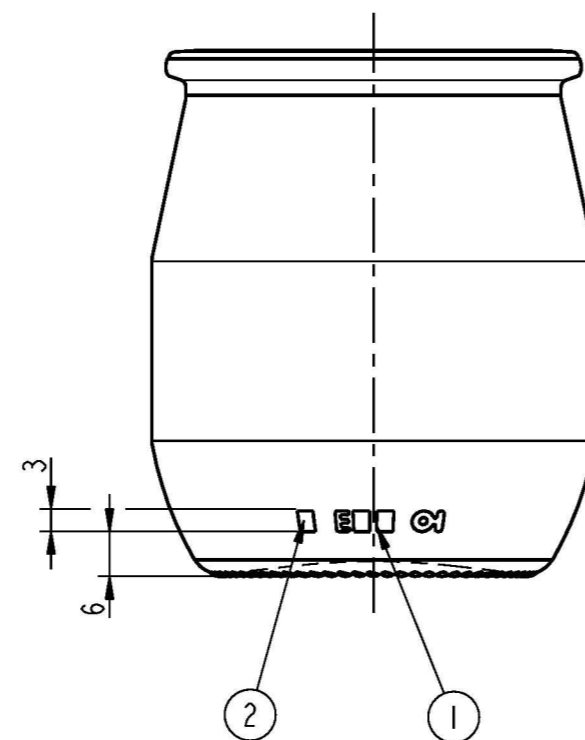
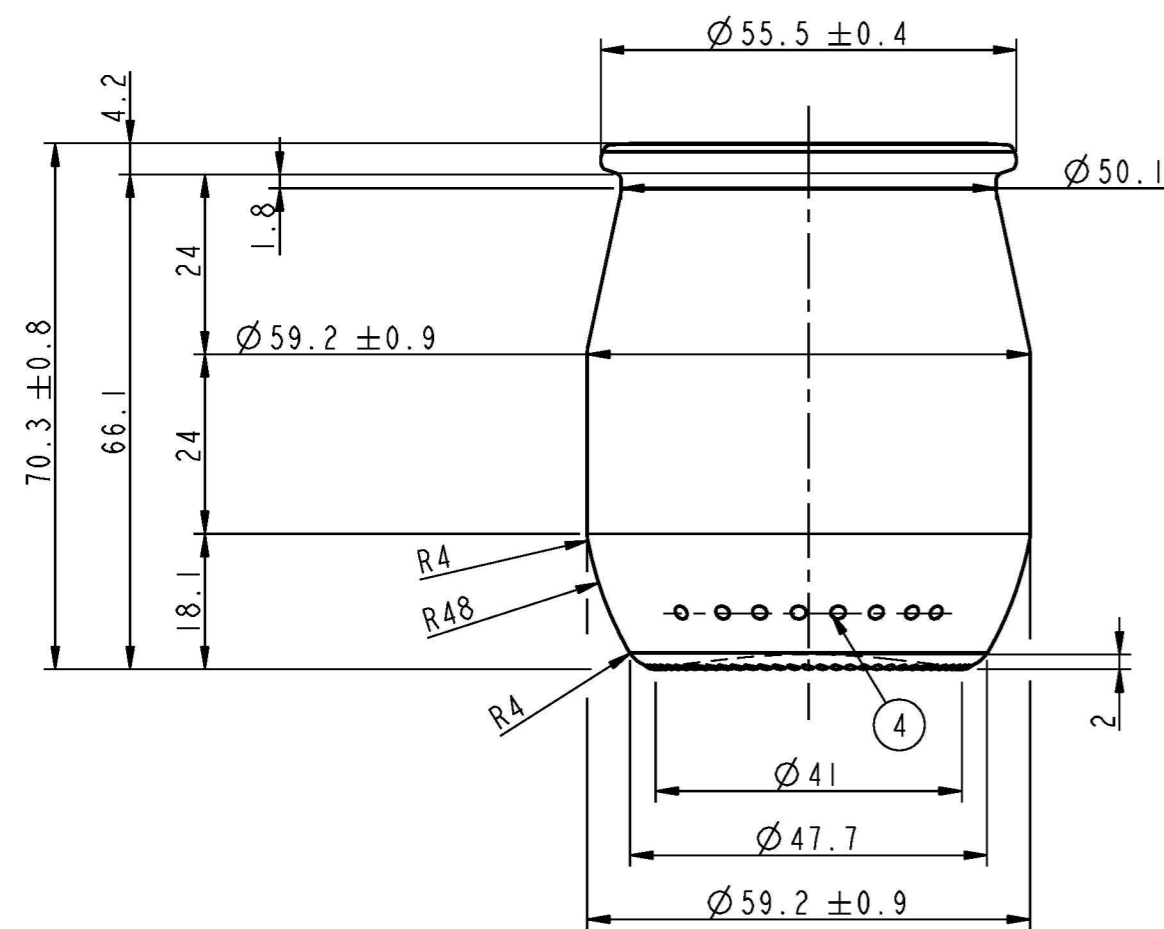

1 = TRADEMARK
 2 = CAVITY No.
 3 = STIPPLING
 THE SHAPE OF STIPPLES IS ONLY AN
 INDICATION AND THE CONSTRUCTION IS AT
 THE PRODUCTION PLANT DISCRETION.
 4 = CAVITY CODE

SCALE 1:1

CATEGORY FOOD		TILT ANGLE 33.46°	
MAX. VERTICALITY TOLERANCE ± 1.5 mm		MEASURING CONTAINER NO	
FINISH SAP NUMBER 3713		FINISH REF. SPECIAL	
MINIMUM THROUGH BORE 45.6 mm		MAX FILLING TUBE Ø 42 mm	
CONTAINER OVERFLOW CAPACITY (BRIMFUL) 143ml ± 5ml			
CONTAINER RATED CAPACITY (FILLPOINT)			
CONTAINER WEIGHT 73g APPROX.			
FINISH DESIGNATION FR_53_SPECIAL_H42_3713		MAX GAS VOLUME	
PROCESS	RETURNABLE NO	DESIGN REF. 6679-01 A 14-1466	

143ml Yaourt Lisse

DESIGNER	M.Sa.	DATE	14.07.2009
CHECKED		DATE	

DRAWING NUMBER 090485	MOULD/SAP NUMBER 013355
---------------------------------	-----------------------------------

No	DATE	REVISIONS	DESIGN/CHECK