

# MPU SERIES CONNECTOR

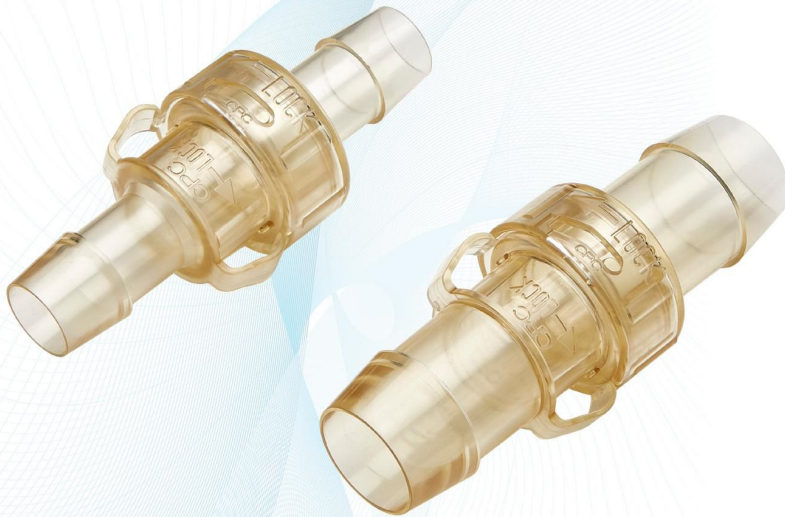

## Specifications ● ● ●

### PRESSURE:

Vacuum to 35 psi, 2.4 bar

### TEMPERATURE:

-40°F to 300°F (-40°C to 149°C)

### MATERIALS:

#### Main components:

Polysulfone (amber tint), USP Class VI, ADCF

O-rings: Silicone (clear), platinum-cured, USP Class VI, ADCF

### STERILIZATION:

**Gamma:** Up to 50 kGy irradiation

**Autoclave:** Up to 270°F (132°C) for 60 minutes, up to 25 repetitions. Sterilize uncoupled only.

### TUBING SIZE:

3/4" ID (19.0mm), 1" ID (25.4 mm)

**WARNING:** Pressure, temperature, chemicals, and operating environment can affect the performance of couplings. It is the customer's responsibility to test the suitability of CPC's products in their own application conditions.

The MPU's twist-to-connect design features an easy-to-use locking mechanism that guards against accidental disconnects and provides a reliable, secure connection. A 3/4" and 1" hose barb provides smooth, rapid media transfer.

## FEATURES

3/4" and 1" hose barb

Locking feature

Sharp barb end

Shrouded, leak-free seal & smooth, internal flow path

ADCF-free materials

Easy to use thumb latch

## BENEFITS

Facilitates rapid fill and empty of bioprocessing bags

Guards against accidental disconnects

Minimizes fluid turbulence and dead space

Protect valuable fluids and eliminate potential to contaminate fluid path

Meet BSE/TSE requirements

Simplifies opening and closing

## MPU Flow Results

The CV value is the estimated GPM flow of water resulting in a 1 PSI pressure drop across the connector set

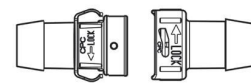

MPU 3/4"

CV value 20

MPU 1"

CV value 37

# MPU SERIES CONNECTOR DIMENSIONS

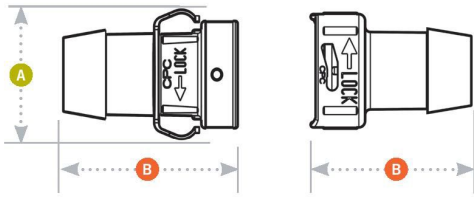

**A** = Height/Diameter  
**B** = Total Length

## Coupling Bodies • POLYSULFONE



**TERMINATION**  
**IN-LINE HOSE BARB**

**TUBING**  
 3/4" ID  
 1" ID

**METRIC EQ.**  
 19.0mm ID  
 25.4mm ID

**FLOW**  
 .71"  
 1"

**STRAIGHT THRU**  
 MPU171239  
 MPU171639

A	B
1.75" (44.5mm)	2.37" (60.2mm)
1.75" (44.5mm)	2.57" (60.3mm)

## Coupling Inserts • POLYSULFONE



**TERMINATION**  
**IN-LINE HOSE BARB**

**TUBING**  
 3/4" ID  
 1" ID

**METRIC EQ.**  
 19.0mm ID  
 25.4mm ID

**FLOW**  
 .71"  
 1"

**STRAIGHT THRU**  
 MPU221239M  
 MPU221639M

**O-RING**  
 Silicone Seal USP Class VI  
 Silicone Seal USP Class VI

A	B
1.9" (48.3mm)	2.88" (73.2mm)
1.9" (48.3mm)	2.88" (73.2mm)

## Accessories • POLYSULFONE



**SEALING CAP**  
 MPU32039

**MATERIAL**  
 Polysulfone

**A**  
 1.75" (44.5mm)

**B**  
 .79" (20.1mm)

USP Class VI

**SEALING PLUG**  
 MPU30039M

**O-RING**  
 Silicone Seal

**MATERIAL**  
 Polysulfone

**A**  
 1.56" (39.6mm)

**B**  
 1.38" (35.1mm)

All measurements are in inches (millimeters) unless otherwise noted. Tubing must meet stated inside and outside diameters.

Confidence at every point of connection. 17